

SAFARI



TREK SPORT

2002

FEAST YOUR EYES ON THE UNIQUE NEW TREK SPORT

This all-new compact motorhome has maximum livability, maximum maneuverability, and maximum value. This innovative Safari coach presents a fresh way to get the best of all worlds. Trek Sport offers you the famous Electro-Majic™ bed – available exclusively from Safari. Combine this with the Workhorse Wide Track chassis and a storage capacity that is unbeatable and you'll be traveling in the coach of your dreams for far less than you'd expect.

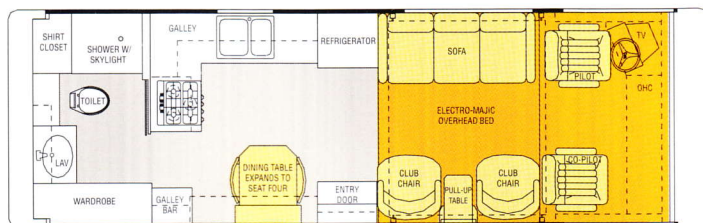

2430

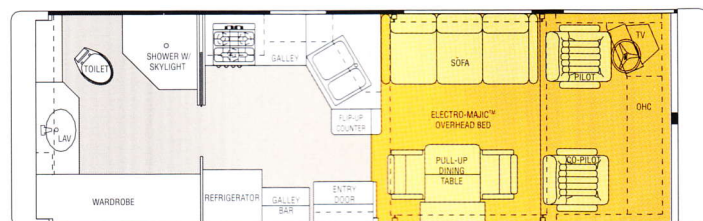

2480

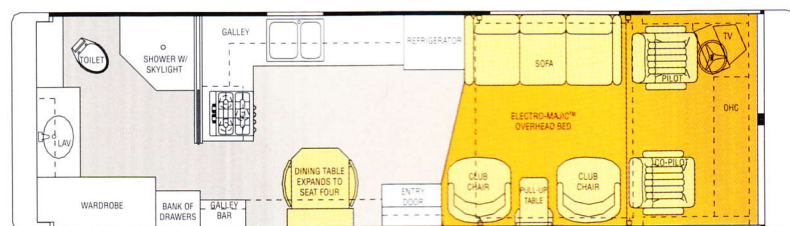

2830



Weights (Lbs.)

	2430	2480	2830
Gross Vehicle Weight Rating	15,000	15,000	17,000
Gross Combined Weight Rating	20,000	20,000	22,000
Gross Axle Weight Rating (Front)	6,000	6,000	6,000
Gross Axle Weight Rating (Rear)	9,000	9,000	11,000

Measurements

	2430	2480	2830
Wheelbase	158"	158"	178"
Overall Length	26' 10"	26' 10"	29' 3"
Height (with A/C)	11' 1"	11' 1"	11' 1"
Interior Height Under Majic Bed/Throughout	75"/78"	75"/78"	75"/78"
Interior Width	93"	93"	93"
Exterior Width	98"	98"	98"

Tank Capacities (Gal.)

All tank capacities are approximate. Actual "Usable Capacity" may vary as a result of variances in installation and fabrication of the tanks.

	2430	2480	2830
Water Heater	6	6	6
Gray Tank	40	40	40
Black Tank	40	40	40
Fresh Tank	80	80	80
LP Tank *	35	35	35
Fuel Tank	60	60	60

*Actual filled LP Capacity is 80% of listing due to safety shut off required on tank.

SPECIFICATIONS

BODY CONSTRUCTION

Aluminum Superstructure
Aluminum Roof
Laminated Aluminum Sidewalls
Front and Rear Molded Fiberglass Caps
Exterior Vinyl Graphics
Laminated Structurwood Flooring
Heated Remote Side View Mirrors
with Turn Signals
Corrosion Resistant Undercoating
Painted Exterior Bay Doors with Struts
Spacious Cargo Storage Compartments
Exterior Assist Handle

OPTIONS

Mural on Rear of Coach

COCKPIT

Fiberglass Automotive Dash
AM/FM/CD Player with 4 Speakers
Rear Vision System with Monitor
Intermittent Windshield Wipers
Tilt Steering Wheel
Electronic Cruise Control
Power Steering
12V Outlet in Cockpit Area
Cloth Pilot Seat
Cloth Co-Pilot Seat

OPTIONS

Six-Way Power Pilot Seat
Six-Way Power Co-Pilot Seat
Air Horns
CB Radio Prep

APPLIANCES AND ACCESSORIES

Norcold® 8 Cu. Ft. Refrigerator
Three-Burner Cooktop
Convection Microwave with Touch Control
20-inch Stereo Color TV with Remote
in Living Area
TV Antenna and Booster
Cable TV Hook-Up and Telephone Jacks

OPTIONS

Fully Automatic Digital Satellite System
VCR
6-Disc CD Changer

INTERIOR

Autumn Haze Oak Vinyl Wrapped Cabinetry
Solid Hardwood Raised Panel Cabinet Doors
Low Friction Roller Drawer Guides
Brass Finished Cabinet Hardware

Laminate Kitchen Countertops with
Stainless Steel Sinks
Laminate Dinette Table with Two Chairs
Laminate Bathroom Countertop
Medicine Cabinet with Mirror
Brass Finish Towel Bars/Rings in Bathroom
Patented ElectroMajic™ Overhead Bed
with Sleep Sac
Plush Carpet and Pad in Living Room
Two Fabric Barrel Chairs (N/A on 2480)
Mini Blinds in Living Room and Dining Area
Fabric Sofa
Vinyl Floor In Kitchen and Bath Area

OPTIONS

Décor Options: Turkana-Soft Jade;
Nyasa-Wheat; Prism-Rose
Walnut Cabinetry

ELECTRICAL SYSTEMS AND LIGHTS

30 Amp Power Cord
Generator Prep
Two 12V Deep Cycle Coach Batteries
House and Chassis Battery Disconnect Switches
Porch Light
Power Entry Step
Lights in Outside Storage Compartment
110V Receptacles Inside Storage Compartment
Computer Hook-Up with Phone Jack in
Dinette Area
Decorative Dining Light
Fluorescent Ceiling Lights in Kitchen
Cosmetic Vanity Lights in Bathroom
Halogen Lights Under Dining Room Cabinet

OPTIONS

Onan® 3.6 kW LP Generator
(with Diesel Chassis)
Onan® 4.0 kW Gasoline Microlite Generator
(with Vortec Chassis)
130-Watt Inverter
5-Watt Solar Charging System with
Control Panel

PLUMBING AND LP SYSTEMS

6-Gallon LP Gas/Electric Water Heater
Water Pump
One-Piece Fiberglass Shower
Glass Shower Door
Systems Compartment with Easy Access
to Hook-Up
Chrome City Water Fill

HEATING, VENTS, AND AIR CONDITIONING

One Dometic® 13.5M BTU Air Conditioner
30M BTU Electronic Ignition Furnace
Electronic AC/Heat Climate Control System
In-Floor Ducted Heating System
12V Attic Fan in Kitchen
12V Attic Fan in Bath

WINDOWS, DOORS AND AWNINGS

Radius® Single Pane Tinted Slider Windows
Radius® Entry Door with Removable Screen
Insulated Skylight in Bathroom
Pocket Door

OPTIONS

Patio Awning
Living Room Window Awning

SAFETY

Fire Extinguisher
Deadbolt Lock on Entrance Door
120V GFI Protected Circuit
(Kitchen, Bathroom)
LP Gas Detector
Smoke Detector
Carbon Monoxide Detector
Pilot and Co-Pilot Seat Belts
Third Brake Safety Light
Egress Window

CHASSIS/ENGINE/SUSPENSION

Wide Track Chassis
Workhorse P-31 8.1L Vortec Front Engine
340 HP @ 4,200 RPM
Torque: 455 lbs./ft. @ 3200 RPM
GM Hydra-Matic 4L80E Transmission
Alternator 145 amp
Radial Tires: 225/70R/19.5
Stainless Steel Wheel Liners
Four Wheel Anti-Lock Disc Brakes
5,000 lb. Hitch Receiver

OPTIONS

6.5L GM Diesel Engine on P-31 Chassis,
190 HP @ 3,400 RPM, Torque
385 Lbs./Ft. @ 1,700 RPM
Hydraulic Leveling System

Due to the large variety of options and floorplan arrangements available to our customers, actual weights for each unit may differ. Safari provides a weight sticker on each unit we produce which includes that unit's tank capacities and approximate weight. Consult your local Safari dealer for unit availability and further information.

The information printed in this brochure reflects product design, fabrication, and component parts at the date of printing. The manufacturer reserves the right, at any time, to make changes in product design, material or component specifications as its sole option, without notice. This includes the substitution

of components of a different brand or trade name which will result in comparable performance. All information printed in this brochure is subject to change after the date of printing. Some features shown or mentioned in this brochure are optional and may only be available in selected floor plans. Photographs may show props or decorations that are not standard equipment on Safari. Safari, the Safari logo and its design, are registered trademarks. All other products and company names are trademarks and/or registered trademarks of their respective holders.

While the color of the motorhome's exterior and the interior fabrics depicted in this sales brochure are fair and reasonable

depictions, the colors depicted may not be an exact match of the actual colors because of the variances in photo-processing and variances caused by inserting the photographs within the sales brochure. Due to product improvements, changes during the model year and/or transcription errors that may occur, information represented within this brochure may not be accurate at the time of your purchase. If certain information is significant to your purchasing decision, please confirm the information with your dealer prior to submitting your order.

Your towed vehicle should be equipped with auxiliary brakes if the weight of the towed load exceeds 1,000 lbs.



As the proud owner of your new Trek Sport by Safari, you will be invited to join Safari International. A chapter of FMCA, the Safari club is a gathering of enthusiasts of Safari, enjoying each other and the travel lifestyle they have found.

Discover magnificent rallies, caravans, and other events throughout the year, as well as updates on what's new with Safari. Share the joy of the RV lifestyle with friends, and it will become more rewarding each and every day.



TREK SPORT

SAFARI

BY MONACO COACH CORPORATION (NYSE: MNC) • 91320 COBURG INDUSTRIAL WAY, COBURG, OREGON 97408
TOLL FREE 1-800-458-8735 • WWW.SAFARIMOTORCOACHES.COM