



TREK04

Adventures as colorful as the people you meet.



The Safari Pride



There's more to owning a Safari motorcoach than just driving. There's also the fun and camaraderie that comes from sharing your adventures with other Safari owners. Because, like you, they know life is to enjoy. And best of all, no matter where you go, you're part of the Safari family. So, sit back and let the good times roll.





Trek 30PBS shown in Fall River.



**You're not
afraid to bend our ear.
We're not afraid
to listen.**

The 2004 Trek is a product of years of listening to our owners, taking their suggestions, and understanding the things that contribute to a superior RV experience. This sporty coach gives you the perfect combination of luxury and agility. It ranges from 26' to 31', yet sacrifices none of the livability you expect from a Safari coach. At night, your sleeping quarters lower from the ceiling at the push of a button. And throughout the day, you'll enjoy a comfortable, easy-to-drive coach that's always ready for your next adventure.



The newly styled automotive dash features a gray hurricane instrument panel and two-tone vinyl. A rear vision system with audio provides added safety, and you'll enjoy numerous conveniences, including a center console with snack tray, and co-pilot side cup holders with magazine rack. You'll also love the comfort of the plush soft touch vinyl cockpit seats. A six-way power pilot seat comes standard, and you may choose an optional six-way power co-pilot seat, as well.



Trek 30PBS shown in Fall River with Regal Cherry cabinetry.

How does the Trek give you so much spaciousness? By raising the amazing Electro-Majic™ bed neatly out of sight during the day to reveal a roomy interior full of style and comfort. You'll choose from seven impressive floorplans, four exquisite interior decors and three styles of beautiful wood cabinetry. As you look closer, you'll also see a number of elegant details, including wood slide-out fascia with fabric inserts, raised panel cabinet doors with brass hardware, and decorative lighting. And to help keep your coach looking great for years to come, we've added new carpeting with Scotchgard™ stain release pad, as well as soil repellant on all fabrics.



The 30PBS features this built-in entertainment center that houses the 25" stereo TV, as well as an optional VCR, DVD player, or home theater system. (A 27" stereo TV wired through the ceiling speakers is standard on all other models.)



This handy systems control center allows you to quickly access many of the coach's important functions.



Creature comforts.

The kitchen area features a full complement of high-quality appliances and — depending on the floorplan you choose — a wide variety of handy details, including a pantry with adjustable shelves, a countertop extension, and overhead cabinets with an adjustable shelf. Other highlights include a solid surface countertop, a stainless steel sink with single-lever chrome faucet, and a separate faucet for filtered water. Laminated plank flooring is standard, while ceramic tile is optional. And while you're in the kitchen, you can enjoy watching TV with our beautiful hardwood cabinet entertainment center (30PBS).



Trek 30PBS shown with Regal Cherry cabinetry.



You'll dine in style at our beautiful hardwood dinette table with two freestanding chairs and two folding chairs.



These stylish day/night pleated shades come standard, and the living area also features blackout shades.



At the touch of a button, our exclusive Electro-Majic™ bed lowers from the ceiling into place and features a comfortable mattress and cozy sleepsac. This efficient solution maximizes your living space and makes the Trek truly one of the most versatile coaches on the road.



The Trek puts every square inch to good use, giving you plenty of cabinet storage space.

You'll find plenty of room for your essentials in this vanity and medicine cabinet with adjustable shelves. The bathroom also features a one-piece fiberglass shower with obscure glass door and brass frame and fixtures — and we've added a new light in the shower with its own switch.



Trek 30PBS shown in Fall River with Regal Cherry cabinetry.



RIVIERA SAND



SPANISH TRAIL



WINDJAMMER



FALL RIVER

ALDER

NATURAL MAPLE

REGAL CHERRY



For a touch of luxury, the 2004 Trek features solid wood square raised panel cabinet doors with brass hardware. You'll also enjoy beautiful laminated plank flooring in the kitchen and bath (or optional ceramic tile). Overhead, there's a soft-touch padded vinyl ceiling that's easy to clean and won't trap smoke or cooking odors.



Showing our colors.

Our designers have created exquisite color combinations for your 2004 Trek. Now you get to choose the one that's right for you.



RIVIERA SAND



SPANISH TRAIL

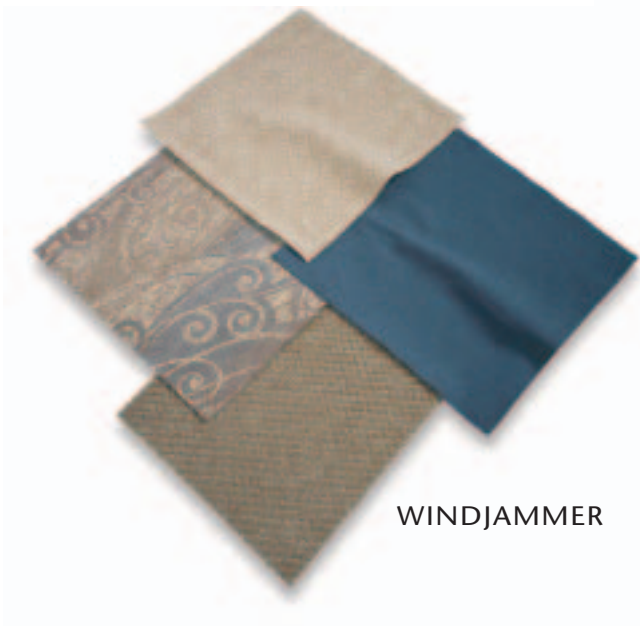

WINDJAMMER



FALL RIVER

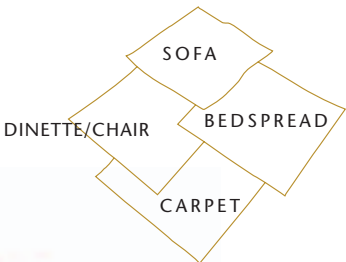

Manufactured in, not added on. 3M Scotchgard™ Carpet Stain Release is applied during the carpet manufacturing process for a higher level of protection. Dupont Teflon® soil repellant is applied to virtually all upholstery fabric during the finishing process for superior coverage.*

*Brand and application of carpet or upholstery fabric protection may vary depending on date recreational vehicle was manufactured.

SmartStructure: The intelligent choice.

Our exclusive SmartStructure provides superior strength, balance and weight distribution while enabling our engineers to make maximum use of space. SmartStructure is fully integrated with your choice of Workhorse or Ford chassis.

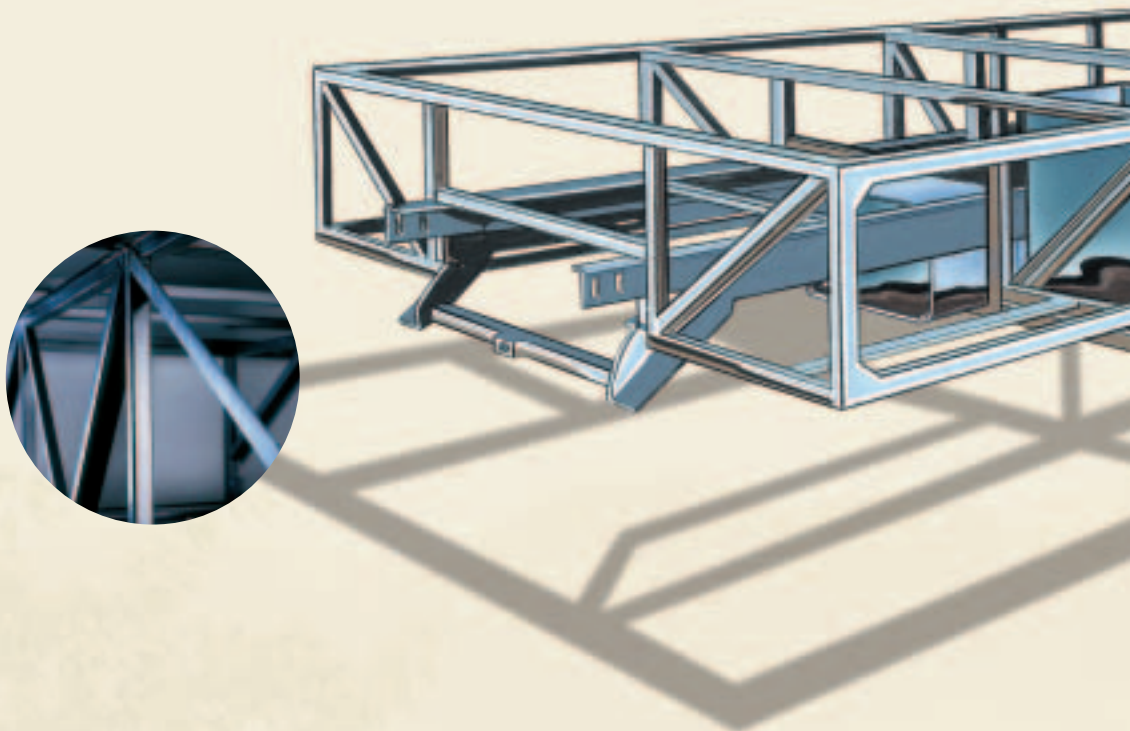

The strength of Alumaframe®

Thanks to our Alumaframe® Superstructure, your Safari coach is built to take on anything the road can dish out. We revolutionized the industry by replacing outdated wood and tubular aluminum construction with our exclusive system of aluminum C-Channel crossmembers. These run the full length of the coach, with double-welded intersections for superior strength. This makes your Safari lighter and sturdier than other coaches and gives you reliability you can count on down the road.

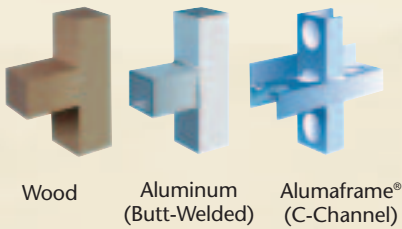

5-Layer Exterior Wall:

- A High-gloss gel coat fiberglass
- B Interlocking C-Channel filled with 1-1/2" fiberglass insulation bonded in place so it doesn't sag or leave spaces uninsulated
- C Vapor barrier
- D Bead foam adds comfort, saves energy and provides a thermal insulative barrier
- E Interior paneling

5-Layer Floor:

- A 5/8" Structurwood™
- B 1-1/2" steel tube
- C Blue foam
- D Luaun
- E Darco

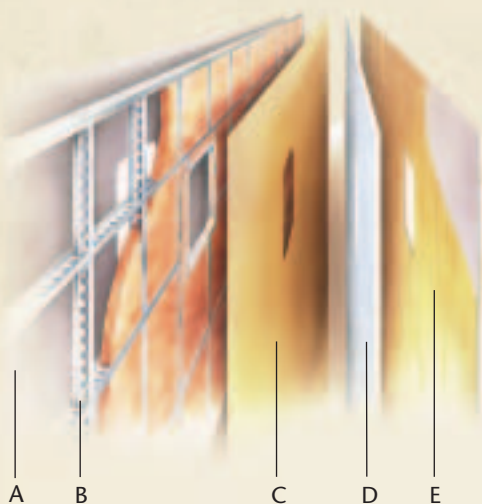



The perfect finish.

Safari coaches are painted in our own state-of-the-art facility using a multi-step paint process to help lengthen the life of your motorhome's exterior. The process includes sanding, application of sealer and base coat, hand-applied graphics, spray painting, and three applications of clear coat.

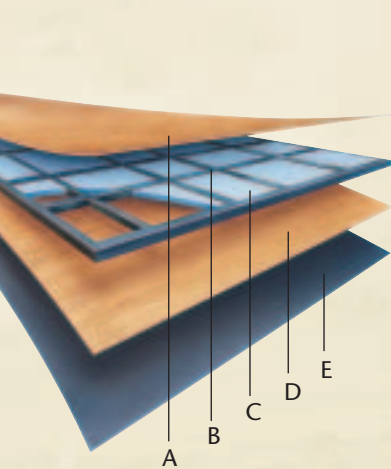

9-Layer Roof:

- A Peaked aluminum roof
- B Luaun backing
- C Thick, tapered bead foam insulation
- D Aluminum double I-beam superstructure filled with fiberglass insulation
- E Vapor barrier
- F Structure foam: thermal insulative barrier
- G 1/2" bead foam insulation
- H Foam padding for extra insulation
- I Padded vinyl ceiling

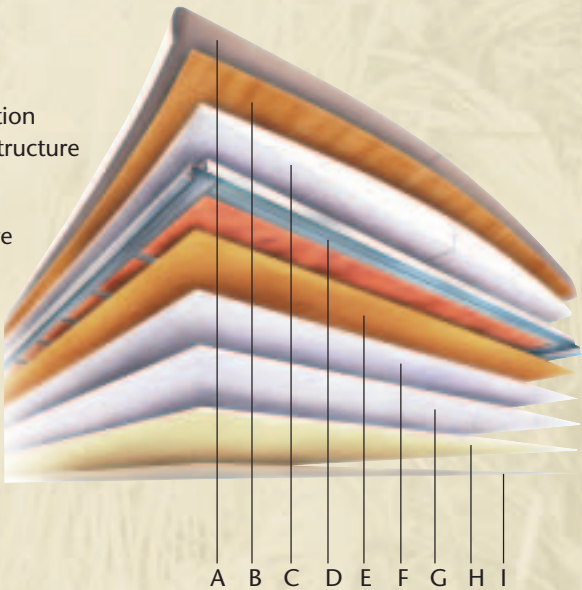



From coast to coast, Safari coaches are recognized by our distinctive optional wildlife murals. Each mural is hand-painted by Dame family craftsmen, and you have your choice of hundreds of designs. Or if you prefer, custom designs are also available.



More than you bargained for.

For 2004, Trek offers you a Super Savings Package designed to provide you with a very affordable, very attractive set of options — allowing you to customize your RV the way you want. Package options include:

- Manual Hydraulic Leveling System
- Six-Way Power Co-Pilot Seat
- Spacesaver Convection Microwave
- VCR and DVD Player
- Plank Flooring, Kitchen and Bath
- Hardwood Raised Panel Doors on Refrigerator
- 12V Wet Bay Heater
- Automatic Patio Awning



Our insulated systems compartment gives you easy access to all your hook-up functions and includes a shower with hot and cold water.



| | 26RB | 26RB2 | 28RB2 | 28RB | 29RBD | 30PBS | 31SBD |
|--|---------|---------|---------|---------|---------|---------|---------|
| Ford Weight Rating (Lbs.) | | | | | | | |
| Gross Vehicle | 18,000 | 18,000 | 18,000 | 18,000 | 20,500 | 20,500 | 20,500 |
| Gross Combined | 23,000 | 23,000 | 23,000 | 23,000 | 25,500 | 25,500 | 25,500 |
| Gross Axle (Front) | 7,000 | 7,000 | 7,000 | 7,000 | 7,000 | 7,000 | 7,000 |
| Gross Axle (Rear) | 11,000 | 11,000 | 11,000 | 11,000 | 13,500 | 13,500 | 13,500 |
| Workhorse Weight Rating (Lbs.) | | | | | | | |
| Gross Vehicle | 17,000 | 17,000 | 18,000 | 18,000 | 20,700 | 20,700 | 20,700 |
| Gross Combined | 22,000 | 22,000 | 22,000 | 22,000 | 25,700 | 25,700 | 25,700 |
| Gross Axle (Front) | 6,000 | 6,000 | 6,000 | 6,000 | 7,500 | 7,500 | 7,500 |
| Gross Axle (Rear) | 11,000 | 11,000 | 12,000 | 12,000 | 13,500 | 13,500 | 13,500 |
| Measurements | | | | | | | |
| Wheelbase | 158.5" | 158.5" | 178" | 178" | 190" | 178" | 178" |
| Overall Length | 26' 10" | 26' 10" | 29' 1" | 29' 1" | 30' 1" | 30' 9" | 31' 9" |
| Ford Height (with A/C) | 11' 6" | 11' 6" | 11' 6" | 11' 6" | 11' 6" | 11' 6" | 11' 6" |
| Workhorse Height (with A/C) | 11' 10" | 11' 10" | 11' 10" | 11' 10" | 11' 10" | 11' 10" | 11' 10" |
| Interior Height (Under Electro-Majic™ Bed/Throughout) | 72"/78" | 72"/78" | 72"/78" | 72"/78" | 72"/78" | 72"/78" | 72"/78" |
| Interior Width | 94.5" | 94.5" | 94.5" | 94.5" | 94.5" | 94.5" | 94.5" |
| Exterior Width | 100.5" | 100.5" | 100.5" | 100.5" | 100.5" | 100.5" | 100.5" |
| Tank Capacities* (Gal.) | | | | | | | |
| Water Heater | 6 | 6 | 6 | 6 | 6 | 6 | 6 |
| Gray Tank | 39 | 39 | 39 | 39 | 39 | 39 | 39 |
| Black Tank | 40 | 40 | 40 | 40 | 40 | 40 | 40 |
| Fresh Tank | 60 | 60 | 60 | 60 | 60 | 60 | 65 |
| LP Tank** | 24 | 24 | 24 | 24 | 24 | 24 | 24 |
| Fuel Tank (Ford) | 75 | 75 | 75 | 75 | 75 | 75 | 75 |
| Fuel Tank (Workhorse) | 60 | 60 | 60 | 60 | 75 | 75 | 75 |

* All tank capacities are estimated based upon calculations provided by the tank manufacturers and represent approximate capacities. The actual "usable capacity" may be greater or less than the estimated capacities based upon fabrication and installation of the tanks.

** Actual filled LP capacity is 80% of listing due to safety shut-off required on tank.

Due to the large variety of options and floorplan arrangements available to our customers, actual weights for each unit can differ significantly. Safari provides a weight sticker on each unit we produce which includes that unit's tank capacities and approximate weight. Consult your local Safari dealer for unit availability and further information. The information printed in this brochure reflects product design, fabrication, and component parts at the date of printing. The manufacturer reserves the right, at any time, to make changes in product design or material or component specifications as its sole option, without notice. This includes the substitution of components of a different brand or trade name, which will result in comparable performance. All information printed in this brochure is subject to change after the date of printing. Some features shown or mentioned in this brochure are optional and may only be available in selected floorplans. Photographs may show props or decorations that are not standard equipment on Safari models. Safari, the Safari logo and its design, are registered trademarks. All other products and company names are trademarks and/or registered trademarks of their respective holders.

While the color of the motorhome's exterior and the interior fabrics depicted in this sales brochure are fair and reasonable depictions, the colors depicted may not be an exact match of the actual colors because of the variances in photo-processing and variances caused by inserting the photographs within the sales brochure. Due to product improvements, changes during the model year and/or transcription errors that may occur, information represented within this brochure may not be accurate at the time of your purchase. If certain information is significant to your purchasing decision, please confirm the information with your dealer prior to submitting your order.

The actual overall length of the recreational vehicle may differ from that indicated in the brochure due to variances in the manufacturing process and/or installed components. The actual length may be greater or less than that indicated.

BODY CONSTRUCTION

Standard Features

Alumaframe® Superstructure
Peaked Aluminum Roof with Fiberglass Insulation
Smooth Aluminum Exterior Walls
Front and Rear Molded Fiberglass Caps with Integrated Bumpers
Steel Framed Floor on Steel Trusses
Laminated Structurwood™ Flooring
Interior Paneling with 3/4" Insulation
Foam Insulated Floor Framing with Luaun Backer
One-Piece Engine Cover
Power Heated Remote Exterior Mirrors
Headlamps with Turn Signals
Baggage Doors with Integrated Single Handle Latches
One-Piece Polyethylene Storage Compartment
Wheel Mud Flaps
Deluxe Full Body Paint
Interior Rubber Entry Step
Exterior Double Entry Steps
Undercoating

Options

Rear Ladder
Mural on Rear Cap (Deletes Rear Window 30PBS, 31SBD)
Full Length Safari Mud Flap

COCKPIT

Standard Features

Fiberglass Automotive Dash with Gray Hurricane Instrumentation Panel and Two Tone Dash Vinyl
CD Player/Radio with Four Speakers
Multi-Positioned Sunvisors
Front Privacy Drape with Tie Backs
Rear Vision System with 7" Monitor and Audio
Intermittent Windshield Wipers
Tilt Steering Wheel
Cruise Control
Power Steering
Roof Mounted Air Horns
Center Console with Cup Holder and Snack Tray
Side Cup Holders for Co-Pilot Seat with Magazine Rack below
Soft Touch Vinyl Pilot and Co-Pilot Recliner Seats with Six-Way Power Pilot Seat
Carpeted Driver and Passenger Floor Mats
Dash Workstation
Smoked Plexiglas® Cabinet Doors over Entertainment Center Systems

Options

Six-Way Power Co-Pilot Seat
Power Sunvisors
Pilot and Co-Pilot Pull Down Sun Shades
AM/FM Cassette (Deletes CD Player)

Ten-Disc CD Player
CB Radio Prep
Driver's Side Door

APPLIANCES AND ACCESSORIES

Standard Features

Large Double-Door Refrigerator with Ice Maker
High-Output Three-Burner Cooktop
Bi-Fold Range Cover
Spacesaver Microwave with Touch Control
27" Stereo TV with Remote Control in Cockpit Living Area (N/A: 30PBS)
25" Stereo TV with Remote Control in Living Area (30PBS)
TV Wired through Ceiling Speakers (N/A: 30PBS)
TV Antenna with TV Jacks
VCR Prep with Video Control Box and Booster
Dual Exterior Hook-Ups for DSS Dish and Cable
Cable TV Hook-Up and Telephone Jacks
Exterior Gas Line Hook-Up Prep for LP Accessories

Options

Large Four-Door Refrigerator with Ice Maker (N/A with Roll-Out Pantry) (N/A: 28RB2, 29RBD, 30PBS, 31SBD)
High-Output Three-Burner Range with Oven
Spacesaver Convection Microwave Washer/Dryer Prep (Requires 10 Gal. Water Heater Option) (26RB, 31SBD)
Combination Washer/Dryer (Requires Washer/Dryer Prep) (26RB, 31SBD)
VCR
DVD Player
Home Theater System
Fully Automatic Digital Satellite System (N/A: 29RBD)
Exterior Entertainment Center (CD Player/Radio with Two Speakers) (N/A: 29RBD, 31SBD)
Fireplace (30PBS, 31SBD)

INTERIOR

Standard Features

Alder Cabinetry
Solid Wood Square Raised Panel Cabinet Doors
Black ABS Refrigerator Inserts
Decorative Wall Board
Wallpaper Border in Kitchen and Bath Area
Self-Supporting Top Hinged Overhead Storage Doors and Positive Catches on All Other Doors
Low Friction Roller Drawer Guides
Brass Finished Entry Rail for Step Well

Brass Cabinetry Hardware and Bath Accessories
Solid Surface Kitchen Countertop with Stainless Steel Sink, Chrome Faucet and Two Sink Covers
Kitchen Countertop Extension (26RB, 29RBD, 30PBS, 31SBD)
Solid Surface Bath Countertop with Integrated Sink
Kitchen Overhead Cabinets with Adjustable Shelf
Kitchen Pantry with Adjustable Shelves next to Refrigerator (Fixed Shelves in 29RBD)
Laminated Plank Flooring in Kitchen and Bath
Nylon Carpeting and Pad with Scotchgard™ Stain Release in Living Area and Bedroom
Soft Touch Padded Vinyl Ceiling
Wood Slide-Out Fascia with Fabric Inserts (29RBD, 30PBS)
Picture Framed Mirror (29RBD, 30PBS)
Full Length Mirror in Bath Area
Medicine Cabinet with Adjustable Shelves
Bath Area Lav Base Mirror with Wood Frame
Towel Bars in Bath Area
Towel Rings in Bath Area
Day/Night Pleated Shades throughout with Blackout Shades in Living Area
Mini Blinds in Bath Area
Soil Repellant on All Fabrics

Options

Decors: Riviera Sand, Spanish Trail, Windjammer, Fall River
Hardwood Cabinetry: Regal Cherry, Natural Maple
Ceramic Tile Flooring in Kitchen and Bath
Roll-Out Pantry (N/A with Four-Door Refrigerator) (N/A: 28RB2, 29RBD, 31SBD)
Raised Refrigerator Panel Inserts

FURNITURE

Standard Features

Electro-Majic™ Bed, Mattress and Sleepsac
Fabric Easy Bed Sofa
Fabric Swivel Barrel Chair(s) (N/A: 26RB, 31SBD)
Flip-Up Party Table (26RB2, 28RB2, 28RB, 29RBD)
Hardwood Dinette Table with Two Freestanding Chairs and Two Folding Chairs

Options

Fabric Barrel Chair and Flip-Up Party Table ILO Sofa (26RB)
Soft Touch Vinyl Euro Recliner with Ottoman and Flip-Up Table ILO Two Barrel Chairs (26RB2, 28RB2, 28RB, 29RBD)

Soft Touch Euro Recliner with Ottoman (30PBS)
Fabric Jackknife Sofa ILO Two Barrel Chairs and Flip-Up Table (26RB2, 28RB2, 28RB, 29RBD)
Fabric Wonderbed
Fabric Electric Sofa (30PBS, 31SBD)
Fabric L-Sofa and Barrel Chair (30PBS)
Fabric L-Sofa ILO Side Desk (31SBD)
Computer Table ILO One Barrel Chair (Requires Euro Recliner with Ottoman) (26PB2, 28RB2, 28RB, 29RBD)
Kitchen Island (29RBD, 31SBD)

ELECTRICAL SYSTEMS AND LIGHTS

Standard Features
50 Amp 120V Distribution Panel and Cord
Onan® 4.0 kW Generator
Four 6V House Batteries
Battery Disconnect Switches
1500 Watt Inverter
12V and 110V Outlets in Cockpit Area
Porch Light
Exterior Power Entry Step with Light
Interior Step Well Entry Step Lights
Water Pump Switch in Service Bay Area, Kitchen, and Bath
Lights in Outside Storage Compartments
120V Receptacles in Outside Storage Compartment
Underhood Utility Light
Computer Hook-Up with Phone Jack in Dinette Area
Pilot and Co-Pilot Map Lights
Snake Light Pilot and Co-Pilot Side Consoles
Systems Control Center
Fluorescent Lights under Kitchen Overhead
Fluorescent Ceiling Lights Throughout
Decorative Framed Galley Fluorescent Light
Decorative Brass Lighting Dinette Overhead, and Cosmetic Vanity Light
Halogen Lights under Living Room Overhead Cabinets

Options
Energy Management System
Solar Panel
Exterior Tank Monitor Gauges
Onan® Gold 5.5 kW Gas Generator

HEATING, VENTS, AND AIR CONDITIONING

Standard Features
One 13.5M BTU Air Conditioner with Ducted Air and Wall Digital Thermostat
31M BTU Electronic Ignition Furnace
Electronic Dash AC/Heat Climate Control System
In-Floor Ducted Heating System with Metal Floor Registers

12V Attic Fan in Kitchen
12V Roof Vent in Bath
12V Attic Fan with Rain Sensor above Electro-Majic™ Bed

Options
Heat Pump for Air Conditioner
12V Wet Bay Heater

PLUMBING AND LP SYSTEMS

Standard Features
Single Lever Chrome Kitchen Faucet
Separate Chrome Kitchen Faucet for Filtered Water
Single Handle Brass Bath Faucet
Demand Water System and Water Pump
6-Gallon LP Gas/Electric Water Heater with Electronic Ignition
Winterization Valving System
Water Heater By-Pass Valve
Toilet with Sprayer
No-Fuss Flush Holding Tank Rinsing System
Insulated Systems Compartment with Easy Access to Hook-Up
Shower inside Wet Bay with Hot/Cold Water
Gravity and Pressurized Water Fill
Sewer Hose Storage Area
One-Piece Fiberglass Shower
Shower Light in Bath Area
Brass Framed Shower Door with Obscure Glass

Options
10-Gallon Gas/Electric Water Heater with Electronic Ignition (N/A: 26RB2)

WINDOWS, DOORS, AND AWNINGS

Standard Features
Radius Flush Mount Dual Pane Safety Glass Dark Tinted Slider Windows
Radius Entrance Door with Clear Glass, Roller Shade, Screen Door and Anti-Skid Steps
Interior Grab Handle and Exterior Grab Handle
Topper Slide-Out Awning (29RBD, 30PBS)
Protecta Glaze Tinted Plexiglas® Skylight in Bath Area
Awning Rail

Options
Patio Awning
Automatic Patio Awning
Window Awnings to Slide-Out Windows (30PBS, 31SBD)
Window Awning

SAFETY

Standard Features
Fire Extinguisher

Deadbolt Lock on Entrance Door
120V GFI Protected Circuit, Kitchen, Bath and Exterior
LP Gas Detector
Smoke Detector
Carbon Monoxide Detector
Integrated Pilot and Co-Pilot Three-Point Seat Belts
Third Brake Safety Light
Egress Windows

CHASSIS/ENGINE/ SUSPENSION

Ford
Electronic Fuel Injection Gasoline Engine 6.8L V10
Cubic Inch Displacement 415~/6.8L
Torque: 425 lbs./ft. Max. Net at 3,250 RPM
4-Speed Automatic Transmission with Overdrive
Fuel Tank Capacity 75 Gallon
130 Amp Alternator
Rear Axle Ratio 5.38:1
Radial Tires 245/70R/19.5F
Stainless Steel Wheel Liners
Leaf Spring Suspension
ABS Brake System
5,000 Lb. Hitch Receiver with Six-Point Connector
SmartStructure

Workhorse
Electronic Fuel Injection Gasoline Engine 8.1L V8
Cubic Inch Displacement 496~/8.1L
Torque: 455 lbs./ft. Max. Net at 340 HP
4-Speed Automatic Transmission with Overdrive (N/A: 29RBD, 30PBS, 31SBD)
5-Speed Automatic Transmission with Overdrive (29RBD, 30PBS, 31SBD)
Fuel Tank Capacity 60 Gallon (N/A: 29RBD, 30PBS, 31SBD)
Fuel Tank Capacity 75 Gallon (29RBD, 30PBS, 31SBD)
145 Amp Alternator
Rear Axle Ratio 4.63:1 (N/A: 29RBD, 30PBS, 31SBD)
Rear Axle Ratio 4.88:1 (29RBD, 30PBS, 31SBD)
Radial Tires: 225/70R/19.5F (N/A: 29RBD, 30PBS, 31SBD)
Radial Tires: 245/70R/19.5 (29RBD, 30PBS, 31SBD)
Stainless Steel Wheel Liners
Leaf Spring Suspension
ABS Brake System
Hitch Receiver with Six-Point Connector
SmartStructure

Options
Hydraulic Leveling System

Floorplans for the way you live.

With the Trek, there's a real feeling of freedom when it comes to floorplans. That's because you have your choice of seven of them, plus plenty of options, too. So, whether you like barrel chairs or a recliner with ottoman, a four-door refrigerator or a roll-out pantry, you're sure to find a floorplan to suit you. That's because the Trek lets you live the way you want, with the space to match.

26RB TREK

TILE CARPET FURNITURE

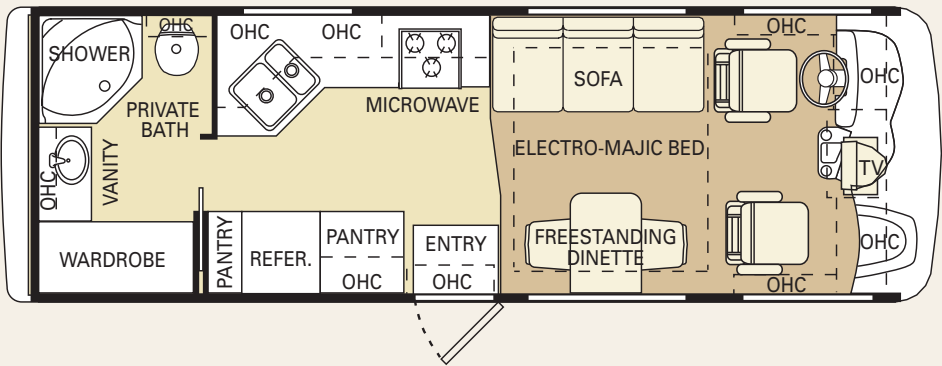

26RB2 TREK

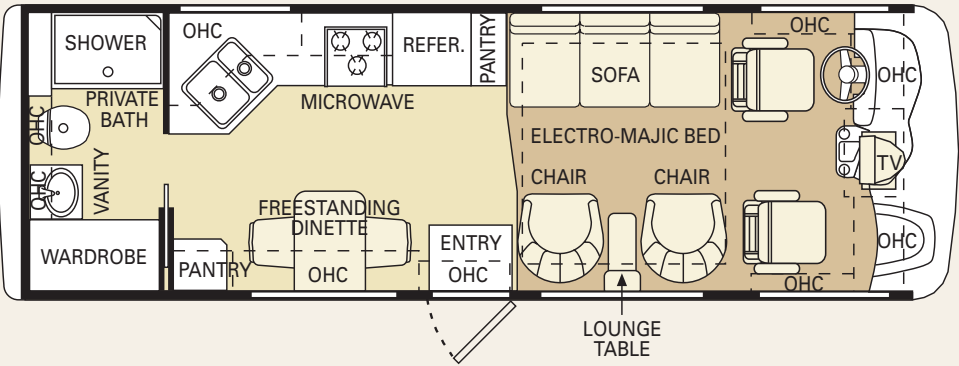

28RB2 TREK

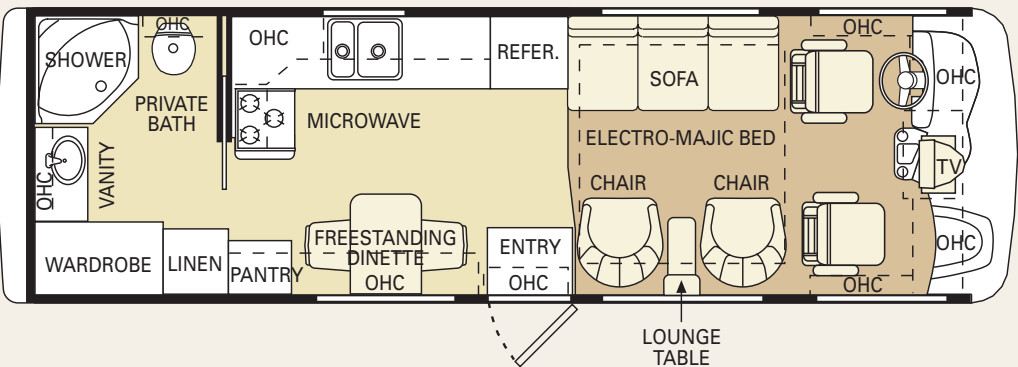

28RB TREK

TILE

CARPET

FURNITURE

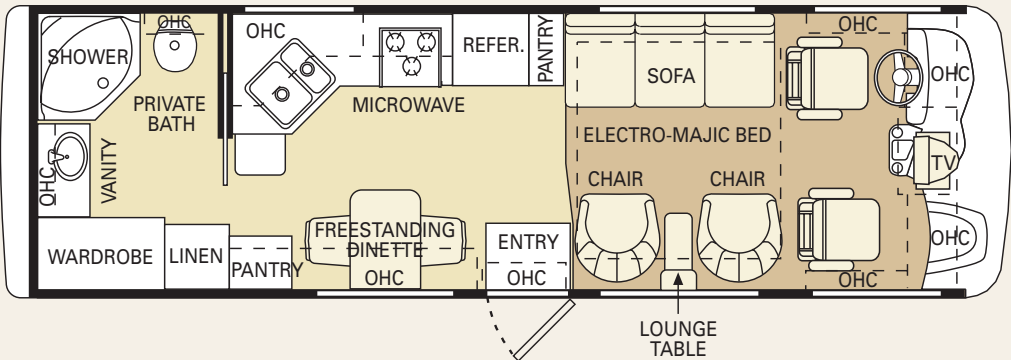

29RBD TREK

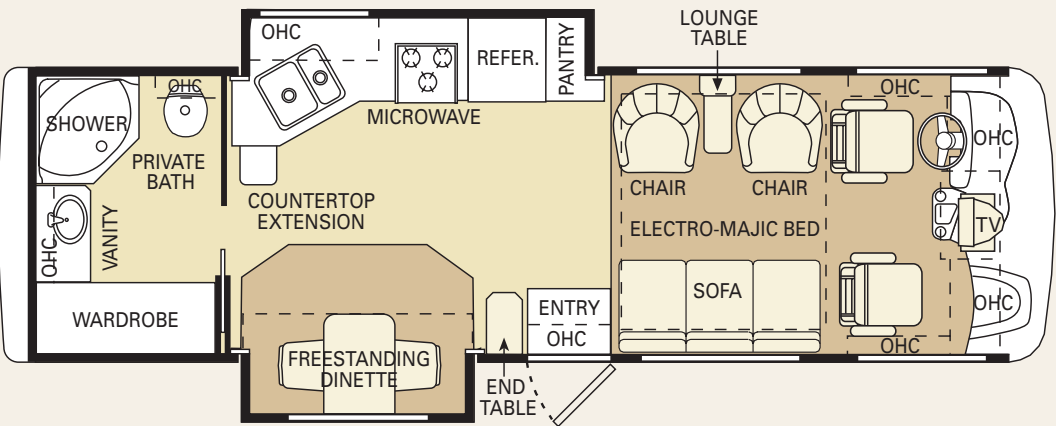

30PBS TREK

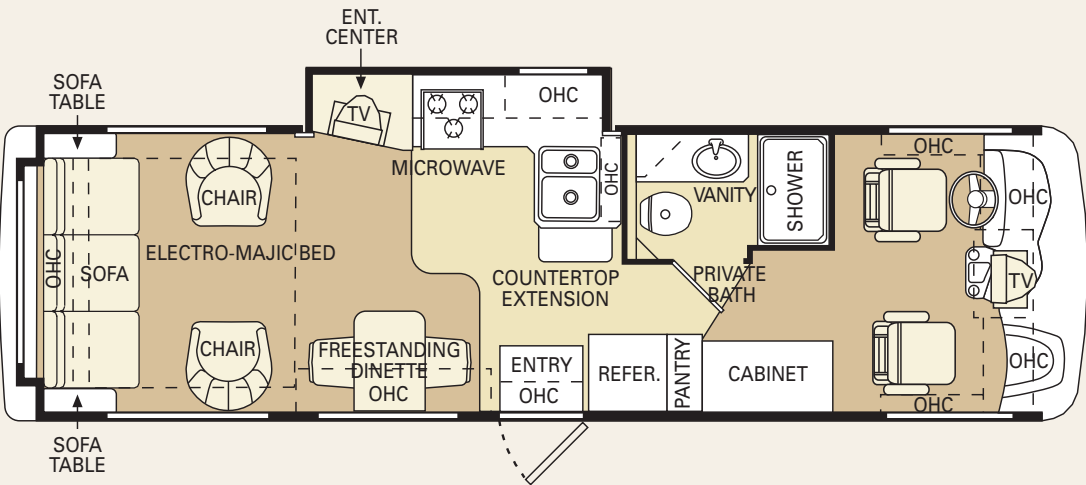

31SBD TREK

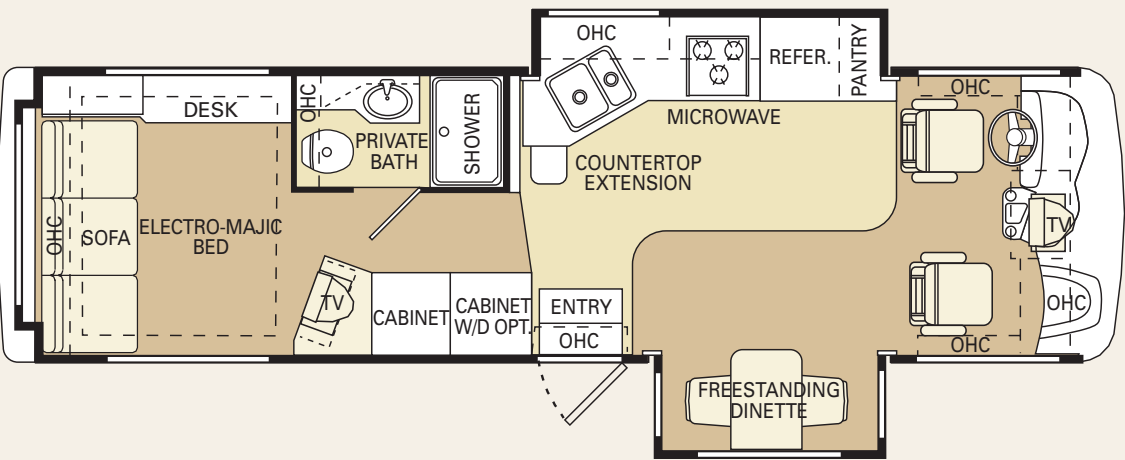

TREK04



Over 1,800 combinations to map out your dream adventure.



Adventures worth sharing.



As a Safari owner, you're entitled to join us throughout the year for rallies designed just for you. You'll meet freedom-loving folks from across the country, all celebrating the adventure of the open road. In addition, you'll enjoy sharing travel information and tips about your coach in our Safari Adventures magazine,

published six times per year. And at www.safarimotorcoaches.com, you'll find a world of information online, right at your fingertips.



Safari's "Women's Only" seminars provide the opportunity for us to get the feminine perspective, which helps us continue designing great motorcoaches.



**No matter where you roam,
the Safari Family Advantage travels with you.**

When you purchase a coach from Safari, you become part of an industry-leading family of companies called Monaco Coach Corporation. What does that mean for you? It means you have access to a wider array of benefits. To begin with, your coach is built by a level of expertise that could only be achieved through the teamwork and combined experience of all our companies. You also get the benefit of our White Glove factory inspection program, for a higher level of quality assurance and added peace of



mind. And your dealer will be happy to tell you about our other innovative programs, including our Extended Care service agreements. Of course, once you're on the road, you'll have access to our nationwide network of more than 350 service facilities, meaning wherever you travel, you're never far from a friend. Ready to roll? In a 2004 Safari, the strength of our entire family is behind you every mile of the way.

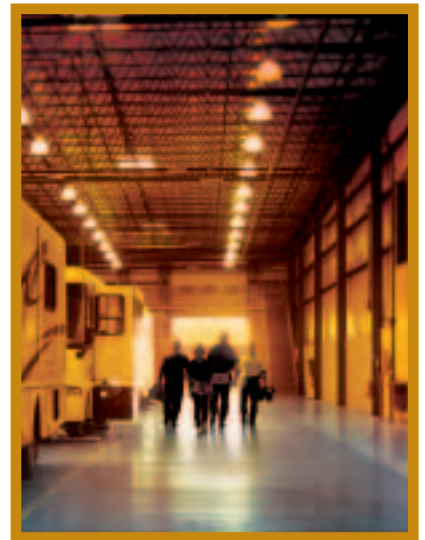

350 | Service
and growing | Facilities
Nationwide



WARRANTIES

12 MONTH/24,000 MILE
basic limited warranty

5 YEAR/50,000 MILE
limited warranty on aluminum or
steel frame structure of sidewall,
roof, front and rear cap

See owner's manual for complete details.



MONACO COACH CORPORATION



Everything but ordinary.

Every Safari comes with the ability to roam free.

There's a spirit in the air. One that whispers freedom — gently urging you to break out and go exploring on your own terms. At Safari, our coaches are bred with a passion for adventure. Whether it takes you to remote mountain hideaways, winding coastal roads or simply across the Midwest to visit



your kids. We've combined the very best in engineering and innovation to give you feature-packed coaches at some of the best values in the industry. But in the end, don't just take our word for it. Visit a Safari dealer near you, and get a real taste of the adventure that lies ahead.

The 2004 Safari Lineage

PANTHER

ZANZIBAR

SAHARA

CHEETAH

TREK

YOUR SAFARI MOTORCOACH DEALER:

Visit our web site at www.safarimotorcoaches.com for the dealer nearest you or call 1-800-634-0855.

BY MONACO COACH CORPORATION • 91320 Coburg Industrial Way • Coburg, OR 97408

© 2003 Monaco Coach Corporation (NYSE: MNC) Printed in USA

0803 NPN: BROSTRE