



TREK® 2005

Live out loud.





LIFE IN THE FUN LANE

Come see why outdoors enthusiasts across the country are choosing the remarkable Trek. This shorter Class-A gas motorhome is easy to drive while making no sacrifices when it comes to livability. Thanks to the exclusive Electro-Majic™ bed, the sleeping area drops from the ceiling at the touch of a button, returning neatly out of sight by day. For 2005, the Trek sports a number of exciting features, including full-body paint, side-hinged baggage doors, flatscreen CRT TVs, and an optional 2,000 watt inverter — all at an amazing value.



Windjammer



Latin Beat



Island Oasis



Outback Lodge

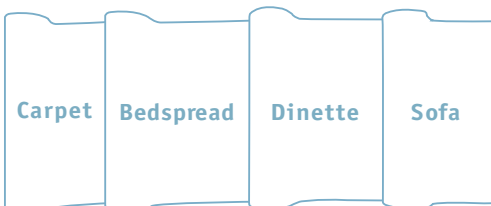

BETTER
STAIN
PROTECTION

Manufactured in, not added on. For added protection against stains, Dupont Teflon® soil repellent is applied to virtually all upholstery fabric during the finishing process for superior coverage.*

* Brand and application of upholstery fabric protection may vary depending on date recreational vehicle was manufactured.



Windjammer



Latin Beat



Island Oasis



Outback Lodge

Note: Exterior Graphics have changed slightly.

Alder (Standard)



Autumn Cherry (Option)



Maple (Option)



TREK FLOORPLANS

Safari craftsmanship. At Safari, we're always giving you more of what you want in a coach — and less of last year's thinking. Take our floorplans. They come straight from you to the drawing board — they're livable, up-to-date and loaded with options. The 2005 Trek offers five imaginative floorplans from which to choose, including single and double slide-outs.



Carpet —  Plank/Tile — 

27RB

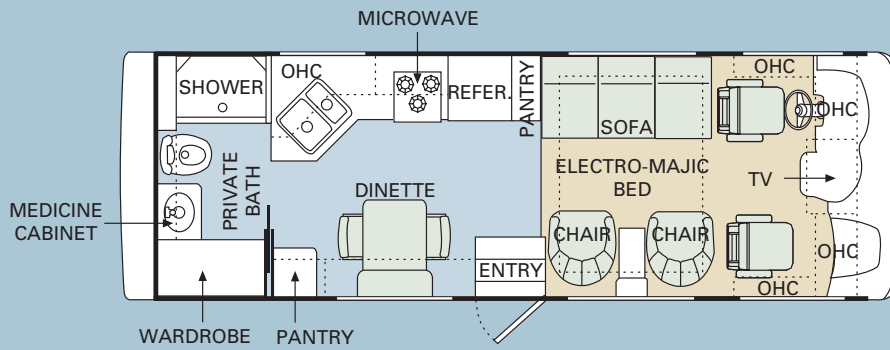

28RB2

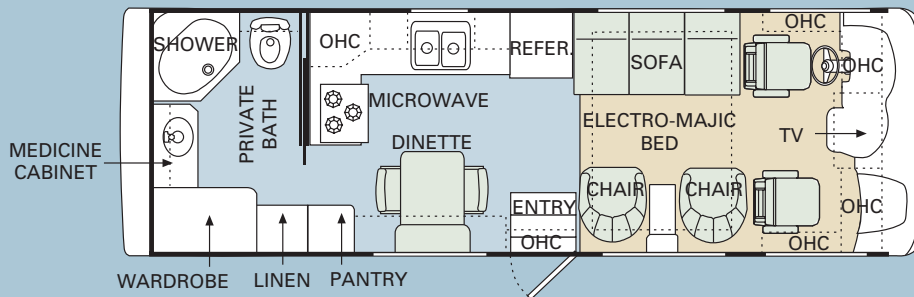

29BD

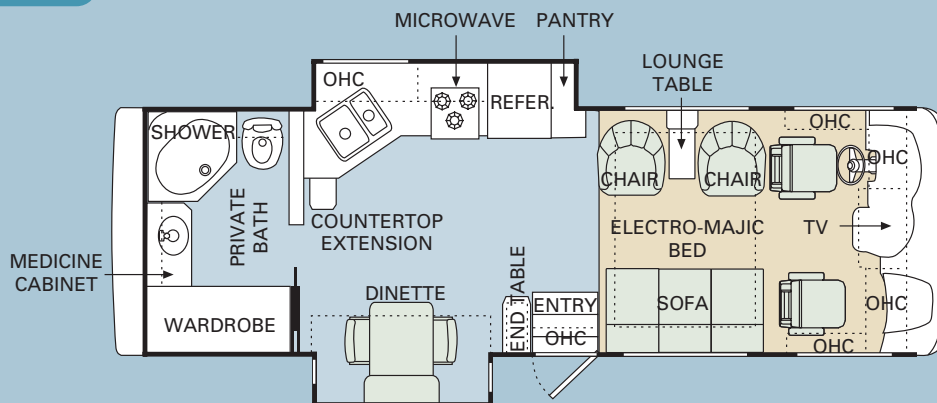

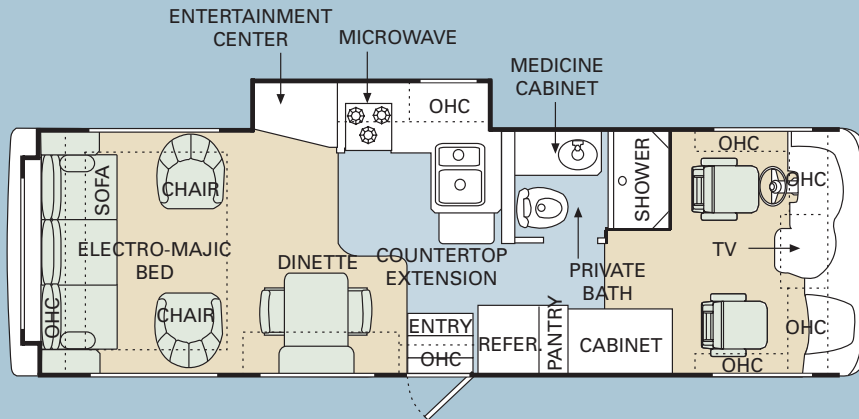

Carpet —  Plank/Tile — 

30PBS

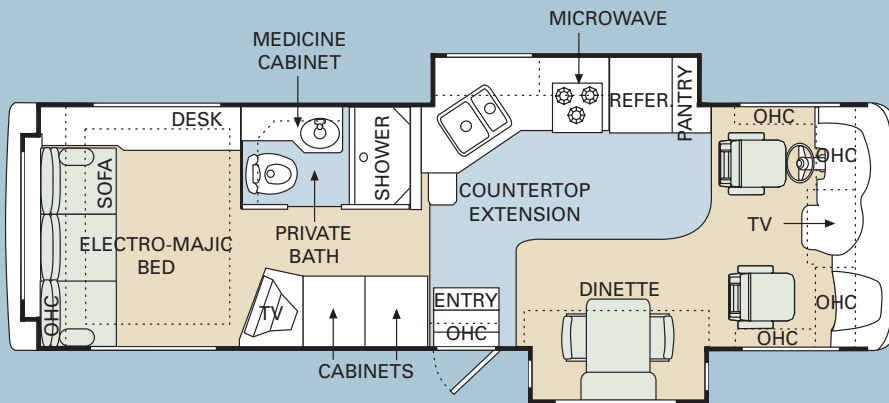

31SBD



www. safarimotorcoaches.com

Visit our website for the latest Safari news, product details, rally information and much more.

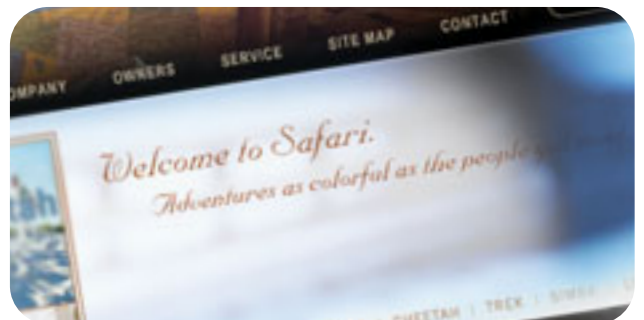

Body Construction

Standard Features

Alumaframe® Superstructure
 Steel Cage Cockpit Construction
 Peaked Aluminum Roof with Fiberglass Insulation
 Smooth Gel Coat Fiberglass Exterior Walls
 Front and Rear Molded Fiberglass Cap
 New Taillights
 Aluminum Framed Floor on Steel Trusses
 Laminated Structurwood™ Flooring
 Interior Paneling with 3/4" Insulation
 One-Piece Engine Cover
 Power Heated Remote Exterior Mirrors, Taller with Bottom Convex
 Headlamps with Turn Signals
 Fog Lights
 Side-Hinged Baggage Doors (Where Available)

One-Piece Polyethylene Storage Compartment
 Wheel Mud Flaps
 Integrated Metal Fuel Door with Lock
 Deluxe Full-Body Paint
 Interior Rubber Entry Steps
 Exterior Double Entry Steps
 Slide-Out Battery Tray
 Undercoating

Options

Rear Ladder
 Mural on Rear Cap
 Chrome Power Heated Mirrors
 Full-Length Mud Flap

Workhorse Chassis, Engine and Suspension

Standard Features

8.1L V-8 Gasoline Engine with Electronic Fuel Injection
 Engine Displacement: 8.1L/496 Cu. In.
 Power: 340 HP; Torque: 455 lbs./ft.
 4-Speed Automatic Transmission with Overdrive (27RB, 28RB2)
 5-Speed Automatic Transmission with Overdrive (29RBD, 30PBS, 31SBD)
 Fuel Tank Capacity 60 Gallon (27RB, 28RB2)
 Fuel Tank Capacity 75 Gallon (29RBD, 30PBS, 31SBD)
 145 Amp Alternator
 Rear Axle Ratio 4.63:1 (27RB, 28RB2)
 Rear Axle Ratio 4.88:1 (29RBD, 30PBS, 31SBD)
 Radial Tires: 225/70R/19.5 (27RB, 28RB2)
 Radial Tires: 245/70R/19.5 (29RBD, 30PBS, 31SBD)

Stainless Steel Wheel Liners
 Leaf Spring Suspension Rear and Coil Front (27RB, 28RB2)
 Leaf Spring Suspension (30PBS, 31SBD)
 ABS Brake System
 4,000 Lb. Hitch Receiver with Seven-Point Connector (27RB, 28RB2)
 5,000 Lb. Hitch Receiver with Seven-Point Connector (29RBD, 30PBS, 31SBD)
 SmartStructure II

Options

Manual Hydraulic Leveling System
 Workhorse 20,700 Lb. Chassis (28RB2)

Ford Chassis, Engine and Suspension

Standard Features

6.8L V-10 Gasoline Engine with Electronic Fuel Injection (N/A: 27RB, 28RB2)
 Engine Displacement: 6.8L/415 Cu. In. (N/A: 27RB, 28RB2)
 Power: 310 HP; Torque: 425 lbs./ft. (N/A: 27RB, 28RB2)
 4-Speed Automatic Transmission with Overdrive (N/A: 27RB, 28RB2)
 Fuel Tank Capacity 75 Gallon (N/A: 27RB, 28RB2)
 130 Amp Alternator (N/A: 27RB, 28RB2)
 Rear Axle Ratio 5.38:1 (N/A: 27RB, 28RB2)
 Radial Tires: 245/70RX/19.5F (N/A: 27RB, 28RB2)

Chrome Wheel Covers (N/A: 27RB, 28RB2)
 Leaf Spring Suspension (N/A: 27RB, 28RB2)
 ABS Brake System (N/A: 27RB, 28RB2)
 5,000 Lb. Hitch Receiver with Seven-Point Connector (N/A: 27RB, 28RB2)
 SmartStructure II (N/A: 27RB, 28RB2)

Options

Manual Hydraulic Leveling System

Cockpit

Standard Features

Fiberglass Two Toned Automotive Dash with Gray Hurricane Instrumentation Panel
 CD Player/Radio with Four Speakers
 Multi-Positioned Sunvisors
 Pleated Front Privacy Drape with Tie Backs
 Rear Vision System with Audio and Adjustable Camera
 Tilt Steering Wheel
 Cruise Control
 Power Steering
 Air Horn
 Redesigned Wood Center Console on Engine Cover, Recess Tray with Rubber Mat, and Plastic Two Tier Cup Holders;
 Front Tip-Door Ford/Front Drawer Workhorse Chassis
 Two-Tier Cup Holder on Co-Pilot Console with Magazine Rack Below
 Soft Touch Vinyl Pilot and Co-Pilot Seats with Six-Way Power Pilot Seat

Carpeted Driver and Passenger Floor Mats
 Dash Workstation
 Directional Map Lights on Bottom of TV Cabinet

Options

Six-Way Power Co-Pilot Seat
 Power Sunvisors
 Pilot and Co-Pilot Pull-Down Sunshades
 CB Radio Prep
 3-Camera Rear Vision System with Audio and Adjustable Center Camera
 Driver's Side Door with Full Electric
 Cassette Radio Option Includes AM/FM Tuner, CD Player, Weather Band
 Ten Disc CD Player

Appliances and Accessories

Standard Features

Large Double-Door Refrigerator with Ice Maker
 High-Output 3-Burner Cooktop
 Bi-Fold Range Cover
 Spacesaver Microwave with Touch Control
 24" Flatscreen CRT Stereo Color TV with Remote Control (N/A: 30PBS)
 24" Flatscreen CRT Stereo TV with Remote Control in Living Area (30PBS)
 TV Wired through Ceiling Speakers
 TV Antenna with TV Jacks
 VCR Prep and Video Control Box with Booster
 Exterior Hook-Ups for DSS and Cable
 Interior Cable TV Hook-Up and Telephone Jacks
 Exterior Gas Line Hook-Up Prep for LP Accessories

Options

Large Four-Door Refrigerator with Ice Maker (27RB)
 Large Double-Door Refrigerator with Ice Maker 10 Cu. Ft. (N/A: 30PBS)
 High-Output Three-Burner Range with Oven
 Spacesaver Convection Microwave with Touch Control
 Washer/Dryer Prep (Requires 10 Gal. Water Heater Option) (31SBD)
 Combination Washer/Dryer (Requires Washer/Dryer Prep) (31SBD)
 VCR
 DVD Player
 Home Theater System
 Fully Automatic Digital Satellite System
 Fireplace (30PBS, 31SBD)
 Exterior Entertainment Center, CD Player Radio with Two Speakers (N/A: 29RBD)

Interior

Standard Features

Alder Hardwood Cabinetry
 Solid Wood Raised Panel Cabinet Doors on Overhead Cabinets, Base Cabinets and Wardrobes
 Black ABS Refrigerator Insert
 Decorative Wallboard
 Self-Supporting Top-Hinged Overhead Storage Doors and Positive Catches on All Other Doors
 Heavy Duty Ball Bearing Drawer Guides
 Wood Cabinet Drawer Boxes
 Crown Molding on All Open Walls (N/A: 27RB, 28RB2)
 Wood Interior Grab Handle on Cabinet at Entry Door (N/A: 27RB, 28RB2)
 Black Entry Rail for Stepwell
 Antique Brass Cabinetry Hardware and Bath Accessories
 Solid Surface Kitchen Countertop with Stainless Steel Sink, Pullout Faucet and Two Sink Covers
 V Grooved Mirrors For Backsplash
 Kitchen Countertop Extension (N/A: 27RB, 28RB2)
 Toe Kicks to Kitchen and Bath Lavatory Base Cabinets
 Solid Surface Bath Countertop with Integrated Sink
 Antique Brass Shower Door and Enclosure
 Silverware Tray in Kitchen Base Cabinet
 Kitchen Overhead Cabinets with Adjustable Shelf
 Kitchen Pantry next to Refrigerator with Adjustable Shelves in Upper Cabinet and Three Drawers Below (N/A with Four Door Refrigerator Option) (28RB2)
 Plank Flooring in Bath, Kitchen and Entry

Nylon Carpeting with Scotchgard™ Stain Release Pad in Cockpit Area
 Soft Touch Padded Vinyl Ceiling
 Decorative Slide-Out Fascia Treatment with Fluted Accent (N/A: 27RB, 28RB2)
 New Style Window Valances
 Decorative Picture on Refrigerator Wall or Pantry Wall or Washer/Dryer Cabinet Wall (N/A: 29RBD)
 Raised Panel Bath Door
 Hardwood Trim for Bath Door Opening Hallway Side
 Full-Length Mirror inside Bath
 Medicine Cabinet with Adjustable Shelves
 Wood Louvers on Washer/Dryer Cabinet Doors (31SBD)
 Towel Bar in Bath
 Two Rings in Bathroom
 Sleepsac for Bed
 Day/Night Pleated Shades Throughout with Blackout Shades in Living Area
 Mini Blinds in Bathroom
 Soil Repellant on Fabric, Teflon® Fabric Protection

Options

Decors: Outback Lodge, Latin Beat, Windjammer, Island Oasis
 Wood Choice: Autumn Cherry and Maple
 Ceramic Tile Flooring in Kitchen and Bath
 Raised Panel Refrigerator Inserts

Furniture

Standard Features

Electro-Majic™ Bed, Mattress Ladder and Sleepsac
 Hardwood Dinette Table with Two Freestanding
 Chairs and Two Folding Chairs
 Roadside: Fabric Sleeper Sofa, Two Pillows on All Sofas
 (N/A: 29RBD, 30PBS, 31SBD)

Roadside: Flip-Up Party Table between Barrel Chairs (29RBD)
 Curbside: Flip-Up Party Table between Barrel Chairs
 (N/A: 29RBD, 30PBS, 31SBD)
 Curbside: Fabric Swivel Barrel Chair (N/A: 29RBD, 31SBD)
 Curbside: Fabric Sleeper Sofa, Two Pillows on All Sofas (29RBD)

Options

Roadside Furniture: Computer Table with Soft Touch Vinyl
 Euro-Recliner and Ottoman (29RBD)
 Roadside Furniture: Fabric Electric Sofa
 (N/A: 30PBS, 31SBD)
 Roadside Furniture: Fabric Wonder Bed Sofa
 (N/A: 30PBS)
 Rear Furniture: Fabric L-Sofa, Two Pillows,
 with Drawer and One Barrel Chair (30PBS)
 Rear Furniture: Fabric L-Sofa, Two Pillows,
 with Drawer (31SBD)
 Rear Furniture: Fabric Electric Sofa (30PBS, 31SBD)
 Rear Furniture: Fabric Wonder Bed Sofa
 (30PBS, 31SBD)

Rear Furniture: Euro-Recliner with Ottoman (30PBS)
 Curbside Furniture: Fabric Sofa with Drawer
 (30PBS, 31SBD)
 Curbside Furniture: Fabric Electric Sofa
 (N/A: 30PBS, 31SBD)
 Curbside Furniture: Fabric Wonder Bed Sofa
 (N/A: 30PBS, 31SBD)
 Headboard and Footboard for Electro-Majic™ Bed
 Curbside Furniture: Computer Table with Soft Touch Vinyl
 Euro-Recliner and Ottoman (27RB, 28RB2)
 Kitchen Island (29PBD, 31SBD)

Electrical System and Lights

Standard Features

30 Amp 120V Distribution Panel and Power Cord
 60 Amp Electronic 12V Converter
 Onan® 4.0 kW Generator
 Two 6V House Batteries
 Battery Disconnect Switches
 12V and 110V Outlets in Cockpit Area
 Porch Light and Exterior Step Light on Same Switch
 Exterior Power Entry Step with Light
 Interior Stepwell Entry Step Lights
 Water Pump Switch in Service Bay Area, Kitchen and Bath
 Lights in Outside Storage Compartments
 120V Receptacles in Outside Storage Compartment
 Underhood Utility Light
 Computer Hook-Up with Phone Jack in Dinette Area
 Pilot and Co-Pilot Map Lights
 Snake Light for Pilot and Co-Pilot Seat Locations
 Systems Control Center

Fluorescent Light(s) with Night Light Function,
 under Kitchen Overhead
 Fluorescent Ceiling Lights Throughout
 Decorative Framed Galley Fluorescent Light
 Decorative Lighting Dinette Overhead and Cosmetic
 Vanity Lights Antique Brass Finish
 Antique Brass Bullet Lights in Living Area
 Halogen Lights under Living Room Overhead Cabinets

Options

50 Amp Service with Energy Management System
 50 Amp 12V Distribution Panel and Cord
 Storage Compartment Tank Monitor Gauges
 2,000 Watt Inverter with Two Additional 6V House Batteries
 Onan® Gold 5.5 kW Gas Generator

Plumbing and LP Systems

Standard Features

Kitchen Stainless Steel Sink with Single Lever Chrome Faucet with Pullout Sprayer
 Separate Faucet for Filtered Water
 Bath Faucet and Bath Hardware Antique Brass
 Demand Water System and Water Pump
 6-Gallon LP Gas/Electric Water Heater with Electronic Ignition
 Winterization Valving System
 Water Heater By-Pass Valve
 China Toilet
 No-Fuss Flush Holding Tank Rinsing System
 Insulated Systems Compartment with Easy Access to Hook-Up
 Shower inside Wet Bay with Hot/Cold Water
 Soap Dispenser inside Utility Bay
 Gravity and Pressurized Water Fill

Contained Storage Area for Sewer Hose
 One-Piece Fiberglass Shower
 Shower Diverter, Hose and Head Antique Brass Finish with Slide Bar for Shower Head with Soap Dish
 Shower Light on Ceiling inside Shower
 Antique Brass Framed Shower Door with Obscure Glass

Options

Bathtub
 RV Sani-Con 2 System, Holding Tank Flush System
 Insta-Hot® Water System
 10 Gallon Gas/Electric Water Heater with Electronic Ignition

Heating, Vents and Air Conditioning

Standard Features

One 13.5M BTU Air Conditioner with Ducted Air and Wall Digital Thermostat, Low Profile Ford and Workhorse
 31M BTU Electronic Ignition Furnace
 Electronic Dash Air Conditioner/Heat Climate Control System
 In-Floor Ducted Heating System with Metal Floor Registers
 12V Attic Fan in Kitchen
 12V Roof Vent in Bath

12V Attic Fan with Rain Sensor above Electro-Majic™ Bed
 Metal Floor Registers Antique Brass

Options

One 13.5M BTU Air Conditioner with Heat Pump, Ducted Air and Wall Digital Thermostat, Low Profile Ford and Workhorse
 12V Wet Bay Heater

Windows, Doors and Awnings

Standard Features

Radius Flush Mount Dual Pane Safety Glass Dark Tinted Slider Windows
 Radius Entrance Door with Clear Glass, Roller Shade, Screen Door and Anti-Skid Steps
 Interior Grab Handle and One Exterior Grab Handle
 Topper Slide-Out Awning (27RB, 28RB2)
 Protecta Glaze Tinted Plexiglas® Skylight in Bathroom
 Awning Rail

Options

Patio Awning
 Automatic Patio Awning
 Window Awnings to Slide-Out House Windows (N/A: 27RB, 28RB2)
 Window Awning on Sidewall

Safety

Standard Features

Fire Extinguisher
 Deadbolt Lock on Entrance Door
 120V GFI Protected Circuit, Kitchen, Bath and Exterior
 LP Gas Detector
 Smoke Detector

Carbon Monoxide Detector
 Pilot and Co-Pilot Three-Point Seat Belts
 Third Brake Safety Light
 Egress Windows



weights & measurements

Weight Ratings Workhorse (Lbs.)	27RB	28RB2	29RBD	30PBS	31SBD
Gross Vehicle Weight Rating	18,000	18,000	20,700	20,700	20,700
Gross Combined Weight Rating*	22,000	22,000	25,700	25,700	25,700
Front Gross Axle Weight Rating	6,000	6,000	7,500	7,500	7,500
Rear Gross Axle Weight Rating	12,000	12,000	13,500	13,500	13,500
Weight Ratings Ford (Lbs.)					
Gross Vehicle Weight Rating	20,500	20,500	20,500	20,500	20,500
Gross Combined Weight Rating*	25,500	25,500	25,500	25,500	25,500
Front Gross Axle Weight Rating	7,000	7,000	7,000	7,000	7,000
Rear Gross Axle Weight Rating	13,500	13,500	13,500	13,500	13,500
Weight Ratings Optional Workhorse (Lbs.)					
Gross Vehicle Weight Rating	N/A	20,700	N/A	N/A	N/A
Gross Combined Weight Rating*	N/A	25,700	N/A	N/A	N/A
Front Gross Axle Weight Rating	N/A	7,500	N/A	N/A	N/A
Rear Gross Axle Weight Rating	N/A	13,500	N/A	N/A	N/A
Measurements					
Wheelbase	178"	178"	190"	190"	190"
Overall Length	27' 6"	29' 1"	30' 1"	30' 9"	31' 9"
Overall Height with A/C, Ford	11' 6"	11' 6"	11' 6"	11' 6"	11' 6"
Overall Height with A/C, Workhorse	11' 10"	11' 10"	11' 10"	11' 10"	11' 10"
Interior Height	74"/78"	74"/78"	74"/78"	74"/78"	74"/78"
Interior Width	94.5"	94.5"	94.5"	94.5"	94.5"
Exterior Width	100.5"	100.5"	100.5"	100.5"	100.5"
Tank Capacities**					
Water Heater	6	6	6	6	6
Gray Tank	40	40	40	40	40
Black Tank	40	40	40	40	40
Fresh Tank	60	60	60	60	60
LP Tank***	24	24	24	24	24

* Towing capacity is limited by GCWR; your vehicle's towing capacity is the difference between the GCWR and the actual vehicle weight, including all water, fuel, passengers and cargo. Your towed vehicle should be equipped with auxiliary brakes if the weight of the towed vehicle exceeds 1,000 lbs. Consult your Owner's Manual for further towing information.

** All tank capacities are estimated based upon calculations provided by the tank manufacturers and represent approximate capacities. The actual "usable capacity" may be greater or less than the estimated capacities based upon fabrication and installation of the tanks.

*** Actual filled LP capacity is 80% of listing due to safety shut-off required on tank.

Due to the large variety of options and floorplan arrangements available to our customers, actual weights for each unit can differ significantly. Safari provides a weight sticker on each unit we produce which includes that unit's tank capacities and approximate weight. Consult your local Safari dealer for unit availability and further information. The information printed in this brochure reflects product design, fabrication, and component parts at the date of printing. The manufacturer reserves the right, at any time, to make changes in product design or material or component specifications as its sole option, without notice. This includes the substitution of components of a different brand or trade name, which will result in comparable performance. All information printed in this brochure is subject to change after the date of printing. Some features shown or mentioned in this brochure are optional and may only be available in selected floorplans. Photographs may show props or decorations that are not standard equipment on Safari models. Safari, the Safari logo and its design, are registered trademarks. All other products and company names are trademarks and/or registered trademarks of their respective holders.

While the color of the motorhome's exterior and the interior fabrics depicted in this sales brochure are fair and reasonable depictions, the colors depicted may not be an exact match of the actual colors because of the variances in photo-processing and variances caused by inserting the photographs within the sales brochure. Due to product improvements, changes during the model year and/or transcription errors that may occur, information represented within this brochure may not be accurate at the time of your purchase. If certain information is significant to your purchasing decision, please confirm the information with your dealer prior to submitting your order.

The actual overall length of the recreational vehicle may differ from that indicated in the brochure due to variances in the manufacturing process and/or installed components. The actual length may be greater or less than that indicated.