

HOLIDAY RAMBLER ✧ 2004 TRAVELER



REDISCOVER AMERICA.







## OUR 50TH ANNIVERSARY.

WHAT BETTER TIME TO RENEW OUR  
VOWS TO THE OPEN ROAD.



IT'S KIND OF AMAZING WHEN YOU THINK ABOUT IT. FIFTY YEARS HAVE GONE BY SINCE WE ROLLED OUT OUR FIRST TRAVEL TRAILER. AND BACK IN 1953, WE BUILT THEM ONE BY ONE IN A GARAGE IN THE HEARTLAND OF INDIANA. BUT EVEN THEN, WE KNEW WE WERE PIONEERING A NEW WAY OF TRAVEL. ONE WHERE THE WHOLE FAMILY COULD EXPERIENCE THIS GREAT COUNTRY OF OURS. AND ONE WHERE THE PEOPLE YOU MET WERE AS MEMORABLE AS THE PLACES YOU VISITED.

THROUGHOUT OUR HISTORY, WE'VE LED THE INDUSTRY IN PERFECTING THE RV LIFESTYLE, WITH COUNTLESS REVOLUTIONARY FEATURES, FROM ALUMINUM FRAMES AND FLAT-FLOOR SLIDE-OUTS TO TRIPLE-SLIDE FLOORPLANS AND BATH-AND-A-HALF MODELS. AND NOW, FROM TOWABLES TO LUXURY MOTORCOACHES, THERE'S A HOLIDAY RAMBLER THAT'S RIGHT FOR YOUR FAMILY.

SO HERE'S TO CELEBRATING FIFTY YEARS ON NORTH AMERICA'S GREAT ROADWAYS. AND HERE'S TO THE PROMISE OF MANY MORE.



This beauty is a Holiday Rambler travel trailer from 1954. Sure we've come a long way since then, but our products are still the same labor of love this one was. If you'd like a closer look, you're welcome to see it on display at the RV Hall of Fame in Elkhart, Indiana.





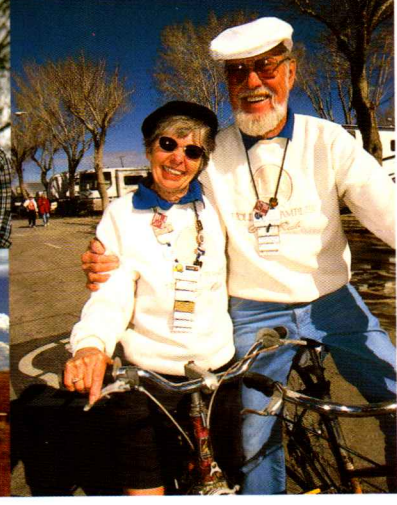
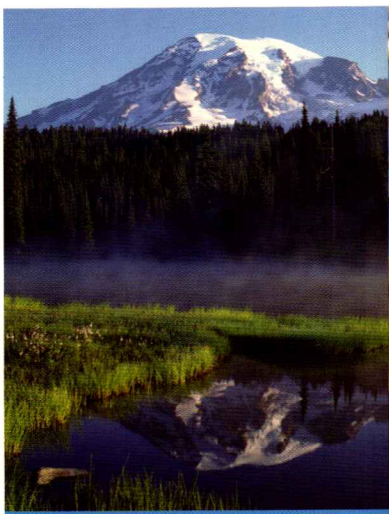



# *M*ET THE CLEVEREST COACH ON THE ROAD.

WHERE CAN YOU FIND THE PERFECT COMBINATION OF LUXURY AND AGILITY? IN THE 2004 TRAVELER. THIS SPORTY COACH RANGES FROM 26' TO 31', YET MAKES NO SACRIFICES WHEN IT COMES TO LIVABILITY. AT NIGHT, YOUR SLEEPING QUARTERS LOWER FROM THE CEILING AT THE



## SLIDE-OUTS AND AWNINGS:

The Traveler features both single and double slide-out models, giving you more space than you ever thought possible. It comes standard with a topper slide-out awning on the 29RBD, 30PBS and 31SBD and offers a variety of other optional awnings.



PUSH OF A BUTTON. AND THROUGHOUT THE DAY, YOU'LL ENJOY ALL THE COMFORTS YOU'D EXPECT FROM A HOLIDAY RAMBLER — IN AN EASY-TO-DRIVE COACH THAT JUST MIGHT OUTSMART THEM ALL.



29RBD in Bahama Bay

2004 TRAVELER







29RBD in Sandpiper with Vintage Oak cabinetry.

THIS YEAR, PUT A LITTLE

“MAJIC” IN YOUR LIFE. ✨

HOW DOES THE TRAVELER PUT SO MUCH LIVABILITY IN A SMALLER COACH? BY RAISING THE AMAZING ELECTRO-MAJIC™ BED NEATLY OUT OF SIGHT DURING THE DAY TO REVEAL A ROOMY INTERIOR FULL OF STYLE AND COMFORT. YOU’LL CHOOSE FROM SIX IMPRESSIVE FLOORPLANS, FOUR EXQUISITE INTERIOR DECORS AND THREE STYLES OF BEAUTIFUL WOOD CABINETRY. AS YOU LOOK CLOSER, YOU’LL ALSO SEE A NUMBER OF ELEGANT DETAILS, INCLUDING WOOD SLIDE-OUT FASCIA WITH FABRIC INSERTS, RAISED PANEL CABINET DOORS AND BRASS FINISHED CABINET HARDWARE AND ENTRY RAIL. AND TO HELP KEEP YOUR COACH LOOKING GREAT FOR YEARS TO COME, WE’VE ADDED NEW CARPETING WITH SCOTCHGARD™ STAIN RELEASE PAD, AS WELL AS TEFLON® FABRIC PROTECTION.



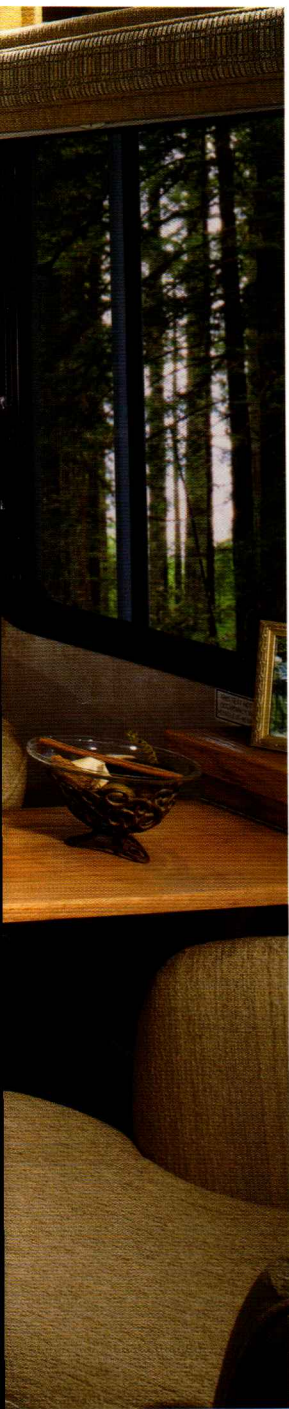

29RBD in Bahama Bay with Vintage Oak cabinetry.



#### KITCHEN AND ISLAND:

The kitchen area features a full complement of high-quality appliances and — depending on the floorplan you choose — a wide variety of handy details, including a pantry with adjustable shelves, a countertop extension, and overhead cabinets with an adjustable shelf. Other highlights include an attractive laminate countertop, a stainless steel sink with single-lever chrome faucet, and a separate faucet for filtered water.

The 29RBD and 31SBD floorplans give you the option of this remarkable kitchen island, for added workspace and storage area.

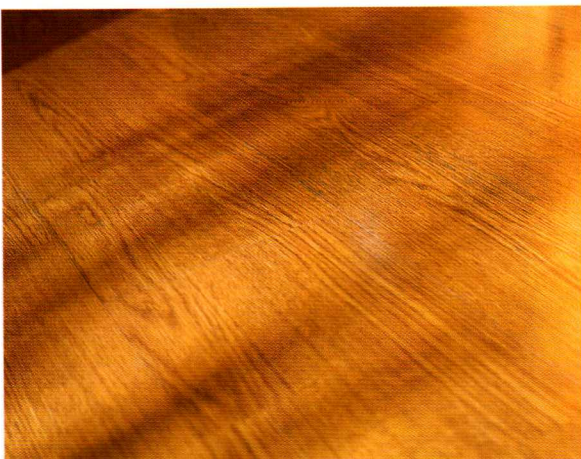

#### PLANK FLOORING:

Beautiful Wilsonart® plank flooring comes standard on the 29RBD and 31SBD floorplans, in the kitchen, bathroom and entryway.





29RBD in Sandpiper with Vintage Oak cabinetry.

**A ELECTRO-MAJIC™ BED:**

At the touch of a button, our exclusive Electro-Majic™ bed lowers from the ceiling into place. You'll enjoy a comfortable mattress and cozy sleepsac, and you'll have the convenience of a ladder. This efficient solution to maximizing your living space has to be seen to be fully appreciated, and it makes the Traveler truly one of the most versatile coaches on the road.

**B BATHROOM:**

The bathroom features a one-piece fiberglass shower with obscure glass door and brass finished frame and fixtures. We've added a new light in the shower with its own switch, and you'll find plenty of room for your essentials in the medicine cabinet with adjustable shelves.



29RBD in Bahama Bay with Vintage Oak cabinetry.





29RBD in Bahama Bay with Vintage Oak cabinetry.

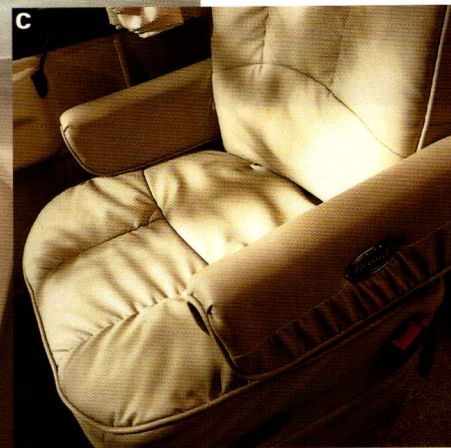

#### DASH:

The newly styled automotive dash features a Roman bronze instrument panel and two-tone vinyl. A rear vision system with audio provides added safety, and you'll enjoy numerous conveniences, including a front privacy drape with tie backs, a center console with snack tray, and co-pilot side cup holders with magazine rack. Power sunvisors, pull-down side sun shades, a driver's side door and a 10-disc CD player all make attractive options.

#### C COCKPIT SEATS:

The plush cockpit seats feature either fabric or optional soft touch vinyl coverings. A six-way power pilot seat comes standard, and you may choose an optional six-way power co-pilot seat, as well.

#### D DASH WORKSTATION:

This dash workstation gives the co-pilot a great surface for reading, writing or using a laptop computer.



THE SMALLER COACH WITH  
A GREAT BIG HEART. ✨

THE TRAVELER MAKES A GREAT FIRST IMPRESSION THANKS TO ITS NEW MOLDED FIBERGLASS FRONT CAP WITH INTEGRATED BUMPER AND NEWLY STYLED HEADLIGHTS WITH TURN SIGNALS. OTHER EXTERIOR DETAILS INCLUDE SMOOTH ALUMINUM SIDEWALLS AND A PAINTED MASK AND SKIRT WITH VINYL GRAPHICS.



# TRAVELER CONSTRUCTION



## ALUMAFRAME® CONSTRUCTION SINCE 1966:

The Traveler features Holiday Rambler's exclusive Alumaframe® Superstructure. Our revolutionary system of aluminum C-Channel crossmembers runs the entire length of the unit, with double-welded intersections for added strength. This rigid design is both lighter and sturdier than wood or tubular aluminum frames — and much more reliable than butt-welded or screwed joint designs. From dirt roads to pot holes, you can count on Alumaframe® to handle the relentless stresses of the road and provide superior structural integrity for many years to come.



Alumaframe®

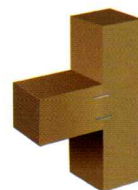

Wood

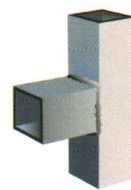

Aluminum  
(Butt-Welded)

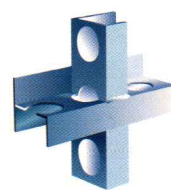

Alumaframe®  
(C-Channel)

## SMARTSTRUCTURE FEATURES:

The SmartStructure provides superior strength, balance and weight distribution while enabling Holiday Rambler engineers to make maximum use of space. SmartStructure is fully integrated with your choice of Workhorse or Ford chassis.

- 1 A hitch receiver with connector provides plentiful towing capacity.
- 2 The SmartStructure technology allows for more under-the-coach storage.

- 3 The steel truss system lowers the center of gravity of the coach and provides a strong platform to carry your coach anywhere you want to go.
- 4 Propane tank, inverter, water heater and batteries are accessible for easy use and service.
- 5 Anti-lock brakes help you stay in control.

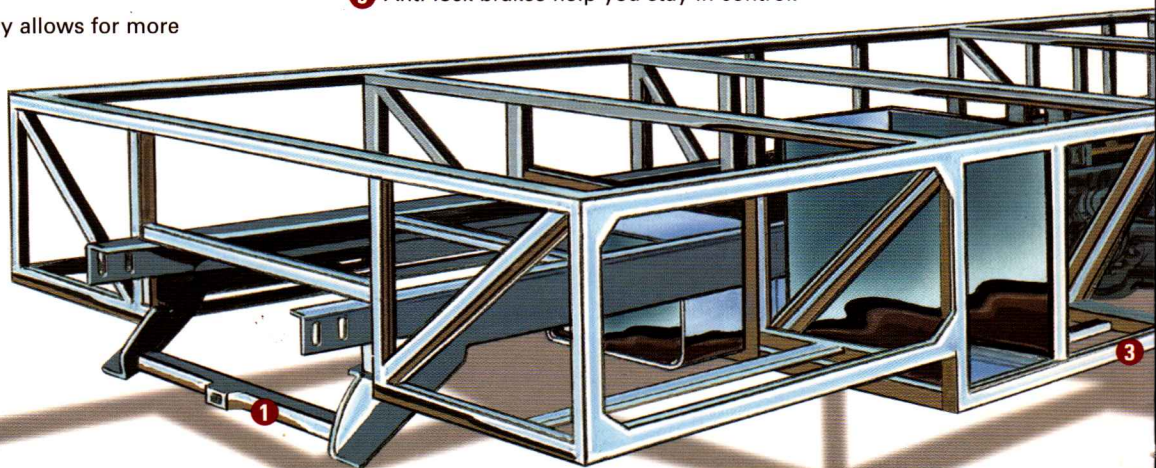

### 9-LAYER ROOF:

- A Peaked aluminum roof
- B Luaun backing
- C Thick, tapered bead foam insulation
- D Aluminum double I-beam superstructure filled with fiberglass insulation
- E Vapor barrier
- F Structure foam: thermal insulative barrier
- G 1/2" bead foam insulation
- H Foam padding for extra insulation
- I Padded vinyl ceiling

### 5-LAYER EXTERIOR WALL:

- A Smooth .063 aluminum is standard
- B Interlocking C-Channel filled with 1-1/2" fiberglass insulation bonded in place so it doesn't sag or leave spaces uninsulated
- C Vapor barrier
- D Bead foam adds comfort, saves energy and provides a thermal insulative barrier
- E Interior paneling



# TRAVELER CONSTRUCTION

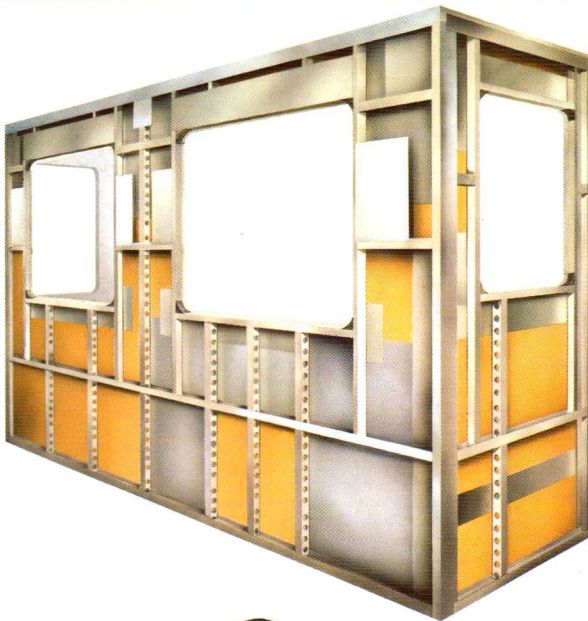

## SLIDE-OUT:

When you get a Holiday Rambler, you can be sure the slide-out boxes are some of the strongest and most reliable you'll find anywhere. They feature our exclusive multi-layer construction to give you maximum insulation and to reduce the chance of warping, twisting or shifting.

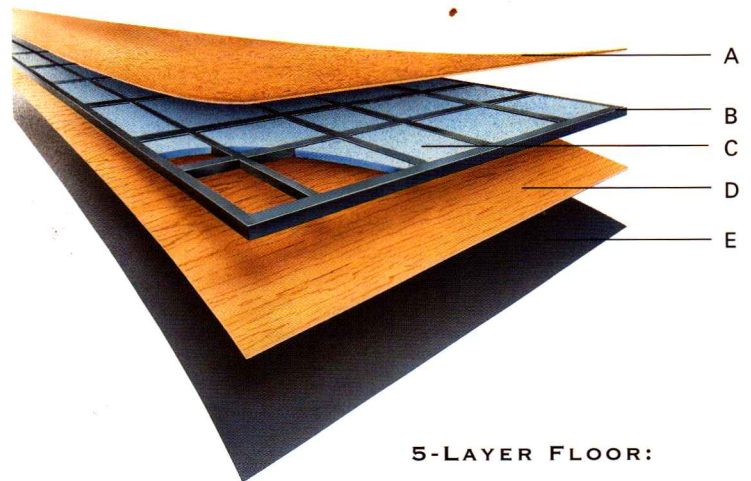
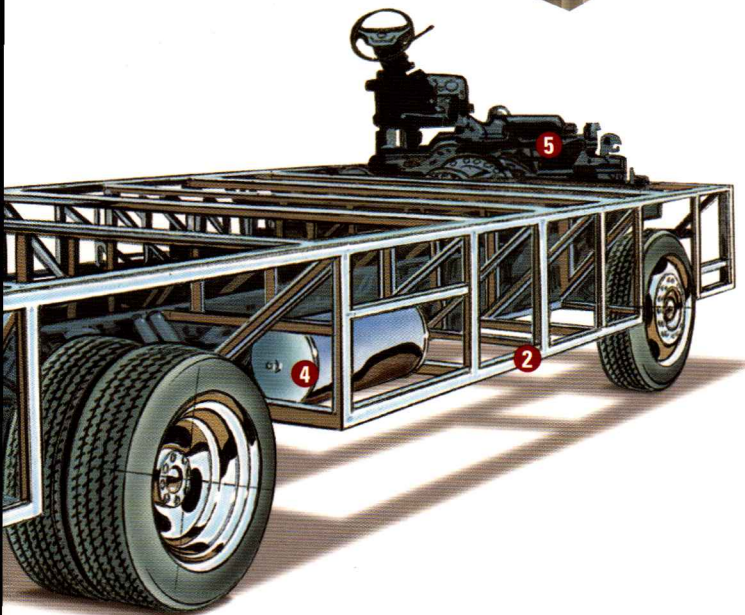

## 5-LAYER FLOOR:

- A 5/8" Structurwood™
- B 1-1/2" steel tube
- C Blue foam
- D Luaun
- E Darco

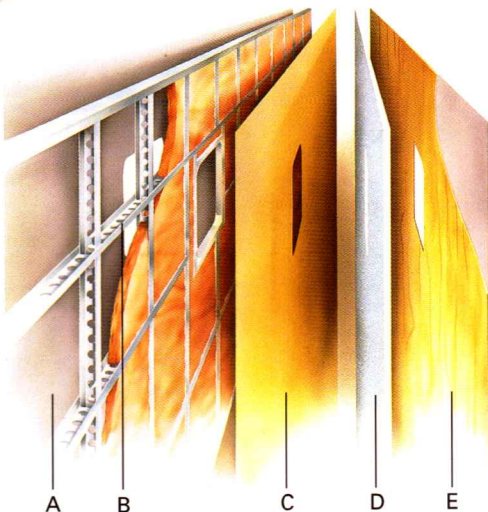

- A
- B
- C
- D
- E



LET THE CHOICES BEGIN.

EACH YEAR, OUR DESIGNERS CREATE BEAUTIFULLY COORDINATED COLOR SCHEMES, WITH RICHLY PATTERNED FABRICS AND ACCENTS. IN THE PAGES THAT FOLLOW, YOU'LL ALSO SEE HOW WE OFFER MORE INNOVATIVE SOLUTIONS TO MAXIMIZING YOUR LIVING AREA — AS WELL AS YOUR VALUABLE STORAGE SPACE. OUR FLOORPLANS TRULY LEAD THE INDUSTRY IN LIVABILITY, WHETHER YOU'RE A FULL-TIMER OR SIMPLY LOOKING FOR THE BEST POSSIBLE FAMILY VACATION.

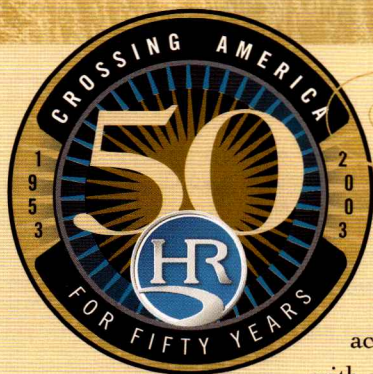

#### SHOWING OUR COLORS FOR 50 YEARS.

It's been 50 years since Holiday Rambler rolled out its first RV. And this is a golden opportunity to honor the thousands of families across North America who've shared the journey with us. They've come to rely on Holiday Rambler for high-quality, innovative products designed to be within the reach of every family that seeks the freedom of the open road. So here's to the last 50 years. And here's to the promise of many more.



#### BETTER STAIN PROTECTION

Manufactured in, not added on. 3M Scotchgard™ Carpet Stain Release is applied during the carpet manufacturing process for a higher level of protection. Dupont Teflon® soil repellent is applied to virtually all upholstery fabric during the finishing process for superior coverage.\*

\*Brand and application of carpet or upholstery fabric protection may vary depending on date recreational vehicle was manufactured.

For 2004, Traveler offers you a Super Savings Package designed to provide you with a very affordable, very attractive set of options (available on 26RB, 26RB2 and 28RB floorplans only).

Package options include:

- Manual Hydraulic Leveling System
- Six-Way Power Co-Pilot Seat
- Spacesaver Convection Microwave
- VCR and DVD Player
- Plank Flooring, Kitchen and Bath
- Hardwood Raised Panel Doors on Refrigerator
- 12V Wet Bay Heater
- Automatic Patio Awning



BAHAMA BAY





EXTERIOR COLORS | FABRICS | WOODS



BLUE WILLOW



PRUSSIAN GOLD



SANDPIPER

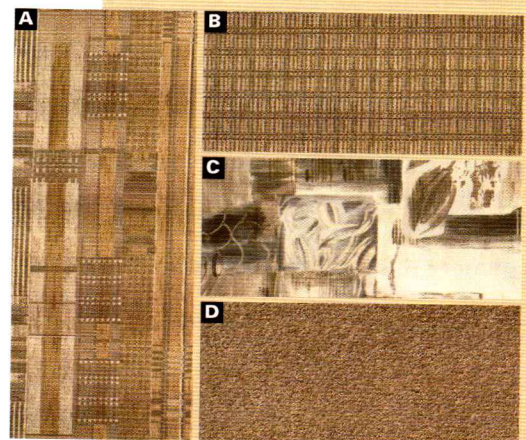
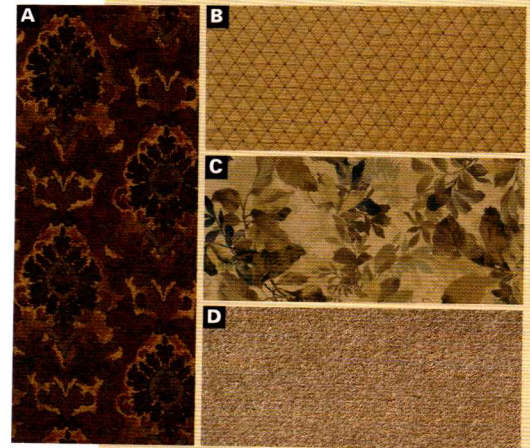
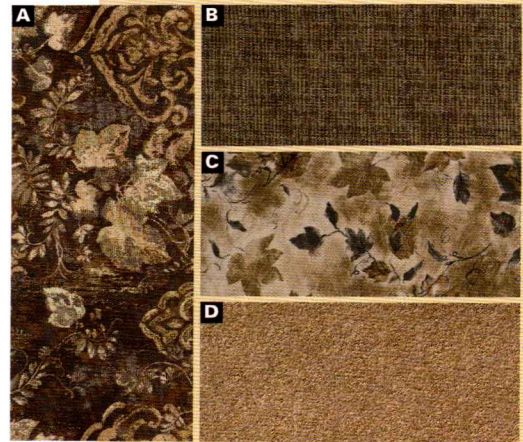

**A** Sofa   **B** Accent   **C** Bedspread   **D** Carpet



VINTAGE OAK

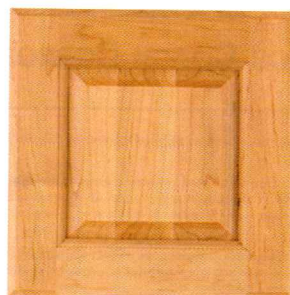

MAPLE

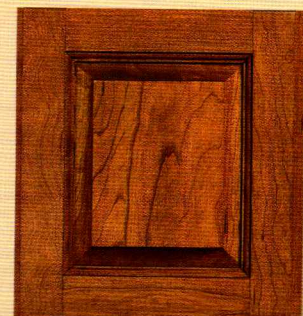

REGAL CHERRY



## THE FAMILY ADVANTAGE



### WE ENCOURAGE YOU TO COMPARE THE HOLIDAY RAMBLER FAMILY ADVANTAGE.

When you purchase a coach from Holiday Rambler, you become part of an industry-leading family of companies called Monaco Coach Corporation. What does that mean for you? It means you have access to a wider array of benefits. To begin with, your coach is built by a level of expertise that could only be achieved through the teamwork and combined experience of all our companies. You also get the benefit of our White Glove factory inspection program, for a higher level of quality assurance and added peace of mind. And your dealer will be happy to tell you about our other innovative programs, including our Extended Care service agreements. Of course, once you're on the road, you'll have access to our nationwide network of more than 350 service facilities, meaning wherever

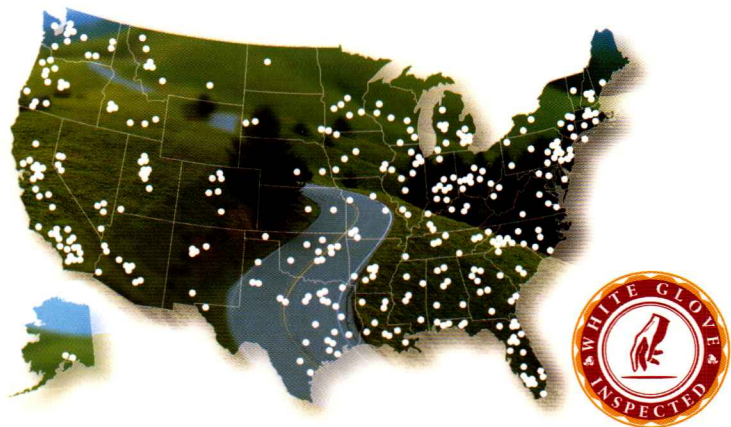

### 350 SERVICE FACILITIES NATIONWIDE AND GROWING.

you travel, you're never far from a friend. Ready to roll? In a 2004 Holiday Rambler, the strength of our entire family is behind you every mile of the way.



### WARRANTIES

**12 MONTH/24,000 MILE**  
basic limited warranty

**5 YEAR/50,000 MILE**  
limited warranty on aluminum or steel frame  
structure of sidewall, roof, front and rear cap

See owner's manual for complete details.



**MONACO COACH CORPORATION**

Due to the large variety of options and floorplan arrangements available to our customers, actual weights for each unit can differ significantly. Holiday Rambler provides a weight sticker on each unit we produce which includes that unit's tank capacities and approximate weight. Consult your local Holiday Rambler dealer for unit availability and further information.

The information printed in this brochure reflects product design, fabrication, and component parts at the date of printing. The manufacturer reserves the right, at any time, to make changes in product design or material or component specifications as its sole option, without notice. This includes the substitution of components of a different brand or trade name, which will result in comparable performance. All information printed in this brochure is subject to change after the date of printing. Some features shown or mentioned in this brochure are optional and may only be available in selected floorplans. Photographs may show props or decorations that are not standard equipment on Holiday Rambler models. Holiday Rambler, the HR logo and its design, are registered trademarks. All other products and company names are trademarks and/or registered trademarks of their respective holders.

While the color of the motorhome's exterior and the interior fabrics depicted in this sales brochure are fair and reasonable depictions, the colors depicted may not be an exact match of the actual colors because of the variances in photo-processing and variances caused by inserting the photographs within the sales brochure. Due to product improvements, changes during the model year and/or transcription errors that may occur, information represented within this brochure may not be accurate at the time of your purchase. If certain information is significant to your purchasing decision, please confirm the information with your dealer prior to submitting your order.

Your towed vehicle should be equipped with auxiliary brakes if the weight of the towed vehicle exceeds 1,000 lbs.

The actual overall length of the recreational vehicle may differ from that indicated in the brochure due to variances in the manufacturing process and/or installed components. The actual length may be greater or less than that indicated.



# SPECIFICATIONS

Weights (Ford)	26RB	26RB2	28RB	29RBD	30PBS	31SBD
Gross Vehicle Weight Rating (Lbs.)	18,000	18,000	18,000	20,500	20,500	20,500
Gross Combined Weight Rating (Lbs.)	23,000	23,000	23,000	25,500	25,500	25,500
Front Gross Axle Weight Rating (Lbs.)	7,000	7,000	7,000	7,000	7,000	7,000
Rear Gross Axle Weight Rating (Lbs.)	11,000	11,000	11,000	13,500	13,500	13,500

Weights (Workhorse)	26RB	26RB2	28RB	29RBD	30PBS	31SBD
Gross Vehicle Weight Rating ( Lbs.)	17,000	17,000	18,000	20,700	20,700	20,700
Gross Combined Weight Rating ( Lbs.)	22,000	22,000	22,000	25,700	25,700	25,700
Front Gross Axle Weight Rating ( Lbs.)	6,000	6,000	6,000	7,500	7,500	7,500
Rear Gross Axle Weight Rating ( Lbs.)	11,000	11,000	12,000	13,500	13,500	13,500

Measurements	26RB	26RB2	28RB	29RBD	30PBS	31SBD
Wheelbase	158.5"	158.5"	178"	190"	178"	178"
Overall Length	26' 10"	27' 6"	29' 1"	30' 1"	30' 9"	31' 9"
Overall Height, Including A/C, Ford	11' 6"	11' 6"	11' 6"	11' 6"	11' 6"	11' 6"
Overall Height, Including A/C, Workhorse	11' 10"	11' 10"	11' 10"	11' 10"	11' 10"	11' 10"
Interior Height (Under Electro-Majic™ Bed/Throughout)	74"/78"	74"/78"	74"/78"	74"/78"	74"/78"	74"/78"
Interior Width	94.5"	94.5"	94.5"	94.5"	94.5"	94.5"
Exterior Width	100.5"	100.5"	100.5"	100.5"	100.5"	100.5"

Tank Capacities *	26RB	26RB2	28RB	29RBD	30PBS	31SBD
Water Heater * (Gal.)	6	6	6	6	6	6
Gray Tank * (Gal.)	39	39	39	39	39	39
Black Tank * (Gal.)	40	40	40	40	40	40
Fresh Tank * (Gal.)	60	60	60	60	60	65
LP Tank ** (Gal.)	24	24	24	24	24	24

\* All tank capacities are estimated based upon calculations provided by the tank manufacturers and represent approximate capacities. The actual "usable capacity" may be greater or less than the estimated capacities based upon fabrication and installation of the tanks.

\*\* Actual filled LP capacity is 80% of listing due to safety shut-off required on tank.



## BODY CONSTRUCTION

### Standard Features

- Alumaframe® Superstructure
- Steel Cage Cockpit Construction
- Peaked Aluminum Roof with Fiberglass Insulation
- Smooth Aluminum Exterior Walls
- Front and Rear Molded Fiberglass Caps with Integrated Bumpers
- Steel Framed Floor on Steel Trusses
- Laminated Structurwood™ Flooring
- Interior Paneling with 3/4" Insulation
- Foam Insulated Floor Framing with Luaun Backer
- One-Piece Engine Cover
- Power Heated Remote Exterior Mirrors
- Headlamps with Turn Signals
- Streamlined Baggage Doors with Integrated Single Handle Latches
- One-Piece Polyethylene Storage Compartment
- Wheel Mud Flaps
- Painted Mask and Skirt with Vinyl Exterior Graphics
- Rear Ladder
- Interior Rubber Entry Step
- Exterior Double Entry Steps
- Undercoating

### Options

- Full Length Holiday Rambler Mud Flap

## FORD CHASSIS/ENGINE/SUSPENSION

### Standard Features

- Electronic Fuel Injection Gasoline Engine 6.8L V10
- Cubic Inch Displacement 415"/6.8L
- Torque @ 3250 RPMs 425 lb./ft.
- 4-Speed Automatic Transmission with Overdrive
- Fuel Tank Capacity 75 Gallon
- 130 Amp Alternator
- Rear Axle Ratio 5.38:1
- Radial Tires 245/70R/19.5F
- Stainless Steel Wheel Liners
- Leaf Spring Suspension
- ABS Brake System
- 5,000 Lb. Hitch Receiver with Connector
- SmartStructure

## WORKHORSE CHASSIS/ENGINE/SUSPENSION

### Standard Features

- Electronic Fuel Injection Gasoline Engine 8.1L V8
- Cubic Inch Displacement 496"/8.1L
- Torque @ 340 HP 455 lb./ft.
- 4-Speed Automatic Transmission with Overdrive (26RB, 26RB2, 28RB)
- 5-Speed Automatic Transmission with Overdrive (29RBD, 30PBS, 31SBD)
- Fuel Tank Capacity 60 Gallon (26RB, 26RB2, 28RB)
- Fuel Tank Capacity 75 Gallon (29RBD, 30PBS, 31SBD)
- 145 Amp Alternator
- Rear Axle Ratio 4.63:1 (26RB, 26RB2, 28RB)
- Rear Axle Ratio 4.88:1 (29RBD, 30PBS, 31SBD)
- Radial Tires: 225/70R/19.5 (26RB, 26RB2, 28RB)
- Radial Tires: 245/70R/19.5 (29RBD, 30PBS, 31SBD)
- Stainless Steel Wheel Liners
- Leaf Spring Suspension
- ABS Brake System
- Hitch Receiver with Connector (5,000 29RBD, 30PBS, 31SBD) (4,000 26RB, 26RB2) (3,000 28RB)
- SmartStructure

### Options

- Manual Hydraulic Leveling System

## COCKPIT

### Standard Features

- Fiberglass Automotive Dash with Roman Bronze Instrumentation Panel and Two Tone Dash Vinyl
- CD Player/Radio with Four Speakers
- Multi-Positioned Sunvisors
- Front Privacy Drape with Tie Backs
- Rear Vision System with 7" Monitor and Audio
- Intermittent Windshield Wipers
- Tilt Steering Wheel
- Cruise Control
- Power Steering
- Electric Automotive Horn
- Center Console with Cup Holder and Snack Tray
- Side Cup Holders for Co-Pilot Seat with Magazine Rack Below

- Fabric Pilot and Co-Pilot Recliner Seats with Six-Way Power Pilot Seat
- Carpeted Driver and Passenger Floor Mats
- Dash Workstation
- Smoked Plexiglas® Cabinet Doors over Entertainment Center Systems
- Secure Front Cab over TVs with Steel Framing (N/A: 30PBS)

### Options

- Six-Way Power Co-Pilot Seat
- Soft Touch Vinyl Pilot and Co-Pilot Seats
- Power Sunvisors
- Pilot and Co-Pilot Pull Down Sun Shades
- CB Radio Prep
- Air Horn
- Driver's Side Door with Full Electric
- Ten-Disc CD Player
- AM/FM Cassette, Deletes CD Player

## APPLIANCES AND ACCESSORIES

### Standard Features

- Large Double-Door Refrigerator with Ice Maker
- High-Output 3-Burner Cooktop
- Bi-Fold Range Cover
- Spacesaver Microwave with Touch Control
- 27" Stereo TV with Remote Control in Cockpit Living Area (N/A: 30PBS)
- 25" Stereo TV with Remote Control in Living Area (30PBS, 31SBD)
- TV Wired through Ceiling Speakers (N/A: 30PBS)
- TV Antenna with TV Jacks
- VCR Prep and Video Control Box with Booster
- Dual Exterior Hook-Ups for DSS Dish and Cable
- Cable TV Hook-Up and Telephone Jacks
- Exterior Gas Line Hook-Up Prep for LP Accessories

### Options

- Large Four-Door Refrigerator with Ice Maker (N/A with Roll-Out Pantry) (N/A: 29RBD, 30PBS, 31SBD)
- High-Output Three-Burner Range with Oven

- Spacesaver Convection Microwave with Touch Control
- Washer/Dryer Prep (Requires 10 Gal. Water Heater Option) (26RB, 31SBD)
- Combination Washer/Dryer (Requires Washer/Dryer Prep) (26RB, 31SBD)
- VCR
- DVD Player
- Fully Automatic Digital Satellite System
- Exterior Entertainment Center, CD Player Radio with Two Speakers (N/A: 29RBD)
- Fireplace (30PBS, 31SBD)

## INTERIOR

### Standard Features

- Vintage Oak Cabinetry
- Raised Panel Cabinet Doors on Overhead Cabinets, Flat Panel Doors on Base Cabinets and Wardrobes
- Cabinet End Panels
- Black ABS Refrigerator Insert
- Decorative Wall Board
- Wallpaper Border in Kitchen and Bath Area
- Self-Supporting Top Hinged Overhead Storage Doors and Positive Catches on All Other Doors
- Low Friction Roller Drawer Guides
- Wood Interior Grab Handle on Cabinet at Entry Door (N/A: 26RB2, 28RB)
- Brass Finished Entry Rail for Step Well
- Brass Cabinetry Hardware and Bath Accessories
- Laminate Kitchen Countertop with Stainless Steel Sink, Chrome Faucet and Two Sink Covers
- Kitchen Countertop Extension (29RBD, 30PBS, 31SBD)
- Laminated Bath Countertop with Laminated Edge
- All Other Countertops Laminate with Wood Edge
- Kitchen Overhead Cabinets with Adjustable Shelf
- Kitchen Pantry with Adjustable Shelves next to Refrigerator (Fixed Shelves 29RBD, 31SBD)
- Linoleum Flooring in Kitchen and Entryway (N/A: 29RBD, 31SBD)
- Wilsonart® Plank Flooring in Bath, Kitchen and Entryway (29RBD, 31SBD)



- Linoleum Flooring in Bathroom (N/A: 29RBD, 31SBD)
- Upgraded Nylon Carpeting with Scotchgard™ Stain Release with Pad in Living Area and Bedroom
- Soft Touch Padded Vinyl Ceiling
- Wood Slide-Out Fascia with Fabric Inserts (29RBD, 30PBS, 31SBD)
- Elongated Octagon Beveled Edge Mirror (29RBD, 30PBS, 31SBD)
- Bath Door with Accent Trim on Hallway Side
- Wood Trim for Bath Door Opening Hallway Side
- Full Length Mirror in Bath Area
- Medicine Cabinet with Adjustable Shelves
- Bathroom Lav Base Mirror with Wood Frame
- Towel Bar Bath
- Two Towel Rings in Bathroom
- Sleep Sac for Bed
- Day/Night Pleated Shades throughout with Blackout Shades in Living Area
- Mini Blinds in Bathroom
- Soil Repellant on Fabric, Teflon® Fabric Protection

## Options

- Decors: Sandpiper, Prussian Gold, Blue Willow, Bahama Bay
- Wood Choice: Regal Cherry, Maple
- Hardwood Raised Panel Doors on Refrigerator
- Laminate Plank Flooring in Kitchen, Bath, and Entryway (N/A: 29RBD, 31SBD)
- Roll-Out Pantry next to Refrigerator with 4 Baskets/8 Baskets in 31SBD (Four-Door Refrigerator Option N/A: 29RBD)

## FURNITURE

### Standard Features

- Electro-Majic™ Bed, Mattress, Sleepsac, and Ladder
- Flip-Up Party Table between Barrel Chairs (26RB2, 28RB, 29RBD)
- Dinette Table with Two Freestanding Chairs
- Fabric Easy Bed Sofa with Two Pillows
- Two Fabric Swivel Barrel Chairs (N/A: 26RB2, 28RB, 29RBD, 30PBS)

## Options

- Fabric Barrel Chairs and Flip-Up Party Table ILO Sofa (26RB)
- Soft Touch Vinyl Euro Recliner with Ottoman (Requires Computer Table Option except on 30PBS) (26RB2, 28RB, 29RBD, 30PBS)
- Fabric Jackknife Sofa ILO Two Barrel Chairs and Flip-Up Table (26RB2, 28RB, 29RBD)
- Fabric Electric Sofa (30PBS, 31SBD)
- Fabric L-Sofa, Two Pillows, with Drawer and One Barrel Chair (30PBS)
- Fabric L-Sofa, Two Pillows and Drawer (31SBD)
- Computer Table IPO One Barrel Chair (Requires Soft Touch Vinyl Euro Recliner with Ottoman) (26RB2, 28RB, 29RBD)
- Kitchen Island (29RBD, 31SBD)
- Two Folding Dinette Chairs

## ELECTRICAL SYSTEMS AND LIGHTS

### Standard Features

- 50 Amp 120V Distribution Panel and Cord
- Onan® 4.0 kW generator
- Four 6V House Batteries
- Battery Disconnect Switches
- 2000 Watt Inverter
- 12V and 110V Outlets in Cockpit Area
- Porch Light
- Exterior Power Entry Step with Light
- Interior Step Well Entry Step Lights
- Water Pump Switch in Service Bay Area, Kitchen and Bath
- Lights in Outside Storage Compartments
- 120V Receptacles in Outside Storage Compartment
- Underhood Utility Light
- Computer Hook-Up with Phone Jack in Dinette Area
- Pilot and Co-Pilot Map Lights
- Snake Light Pilot and Co-Pilot Seat Location
- Systems Control Center
- Fluorescent Lights under Kitchen Overhead
- Fluorescent Ceiling Lights Throughout
- Decorative Framed Galley Fluorescent Light
- Decorative Brass Lighting Dinette Overhead, and Cosmetic Vanity Light

- Bullet Lights in Living Area
- Halogen Lights under Living Room Overhead Cabinets

## Options

- Energy Management System
- Solar Panel
- Storage Compartment Tank Monitor Gauges
- Onan® Gold 5.5 kW Gas Generator

## PLUMBING AND LP SYSTEMS

### Standard Features

- Kitchen Stainless Steel Sink with Single Lever Chrome Faucet
- Separate Chrome Faucet for Filtered Water
- Bath Lav Faucet Single Handle Brass Finish
- Demand Water System and Water Pump
- 6-Gallon LP Gas/Electric Water Heater with Electronic Ignition
- Winterization Valving System
- Water Heater By-Pass Valve
- Toilet with Sprayer
- No-Fuss Flush Holding Tank Rinsing System
- Insulated Systems Compartment with Easy Access to Hook-Up
- Shower inside Wet Bay with Hot/Cold Water
- Gravity and Pressurized Water Fill
- Contained Storage Area for Sewer Hose
- One-Piece Fiberglass Shower
- Shower Light
- Brass Framed Shower Door with Obscure Glass

## Options

- Bath Tub
- 10-Gallon Gas/Electric Water Heater with Electronic Ignition (N/A: 26RB2)

## HEATING, VENTS AND AIR CONDITIONING

### Standard Features

- One 13.5M BTU Air Conditioner with Ducted Air and Wall Digital Thermostat
- 31M BTU Electronic Ignition Furnace
- Electronic Dash AC/Heat Climate Control System

- In-Floor Ducted Heating System with Metal Floor Registers
- 12V Attic Fan in Kitchen
- 12V Roof Vent in Bath
- 12V Attic Fan with Rain Sensor above Electro-Majic™ Bed
- Metal Floor Registers (Antique Brass)

## Options

- One 13.5M BTU Air Conditioner with Heat Pump, Ducted Air and Wall Digital Thermostat
- 12V Wet Bay Heater

## WINDOWS, DOORS AND AWNINGS

### Standard Features

- Radius Flush Mount Single Pane Safety Glass Dark Tinted Slider Windows
- Radius Entrance Door with Clear Glass, Roller Shade, Screen Door and Anti-Skid Steps
- Interior Grab Handle and One Exterior Grab Handle
- Topper Slide-Out Awning (29RBD, 30PBS, 31SBD)
- Protecta Glaze Tinted Plexiglas® Skylight in Bathroom
- Awning Rail

## Options

- Radius Flush Mount Dual Pane Safety Glass Dark Tinted Slider Windows
- Texture Vinyl Patio Awning
- Texture Vinyl Automatic Patio Awning
- Texture Vinyl Window Awnings to Slide-Out House Windows (31SBD)
- Window Awning on Sidewall

## SAFETY

### Standard Features

- Fire Extinguisher
- Deadbolt Lock on Entrance Door
- 120V GFI Protected Circuit, Kitchen, Bath and Exterior
- LP Gas Detector
- Smoke Detector
- Carbon Monoxide Detector
- Pilot and Co-Pilot Three-Point Seat Belts
- Third Brake Safety Light
- Egress Windows



# TRAVELER FLOORPLANS

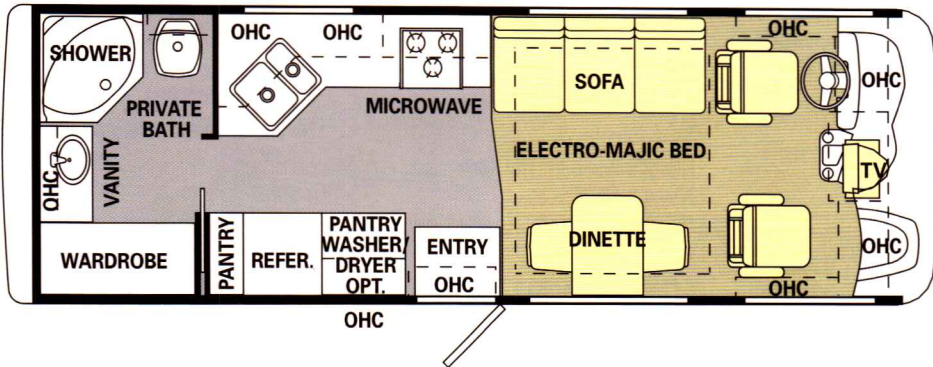

## 26RB

Options Include:  
Fabric Barrel Chairs and  
Flip-Up Party Table  
ILO Sofa  
Two Folding Dinette Chairs

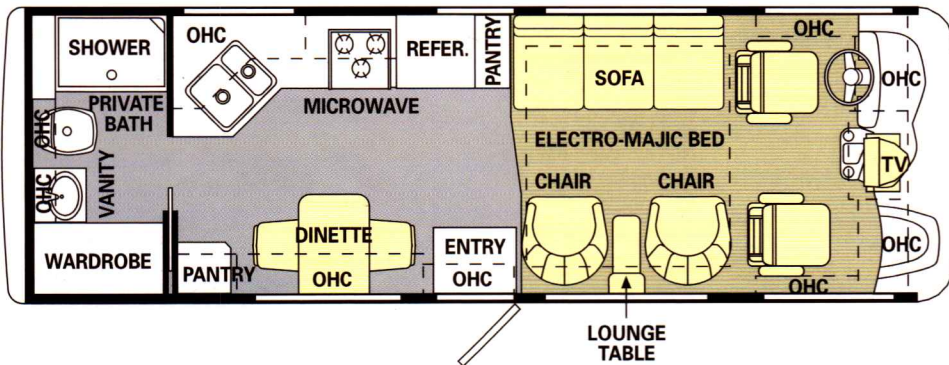

## 26RB2

Options Include:  
Soft Touch Vinyl Euro  
Recliner with Ottoman  
Fabric Jackknife Sofa  
ILO Two Barrel Chairs  
and Table  
Computer Table IPO  
One Barrel Chair  
(Requires Euro Recliner)  
Two Folding Dinette Chairs

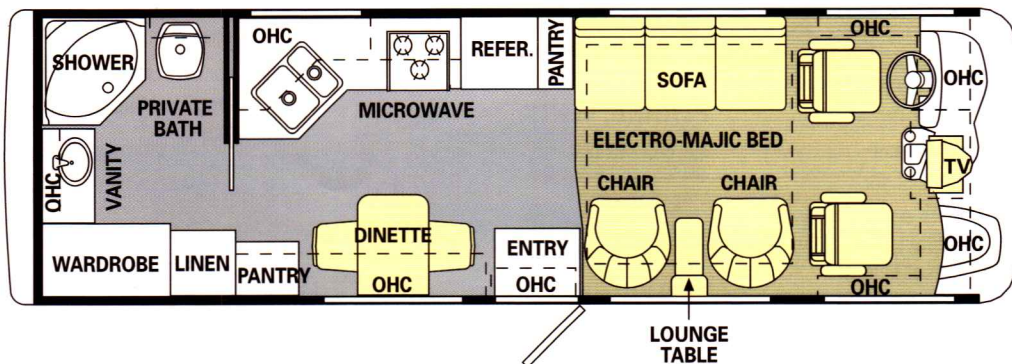

## 28RB

Options Include:  
Soft Touch Vinyl Euro  
Recliner with Ottoman  
Fabric Jackknife Sofa  
ILO Two Barrel Chairs  
and Table  
Computer Table IPO  
One Barrel Chair  
(Requires Euro Recliner)  
Two Folding Dinette Chairs

CARPET

LINOLEUM/  
PLANK  
OPTIONAL



# TRAVELER FLOORPLANS

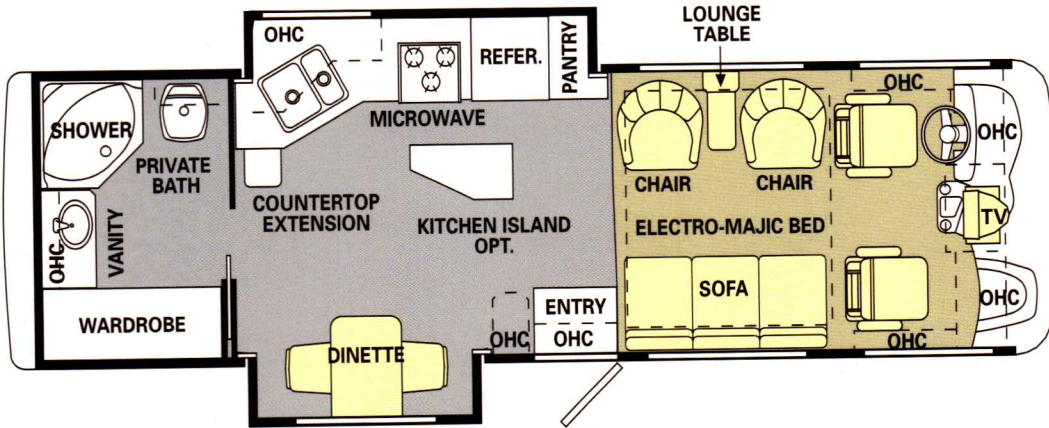

## 29 RBD

Options Include:  
 Soft Touch Vinyl Euro  
 Recliner with Ottoman  
 Fabric Jackknife Sofa  
 ILO Two Barrel Chairs  
 and Table  
 Computer Table IPO  
 One Barrel Chair  
 (Requires Euro Recliner)  
 Two Folding Dinette Chairs  
 Island Kitchen

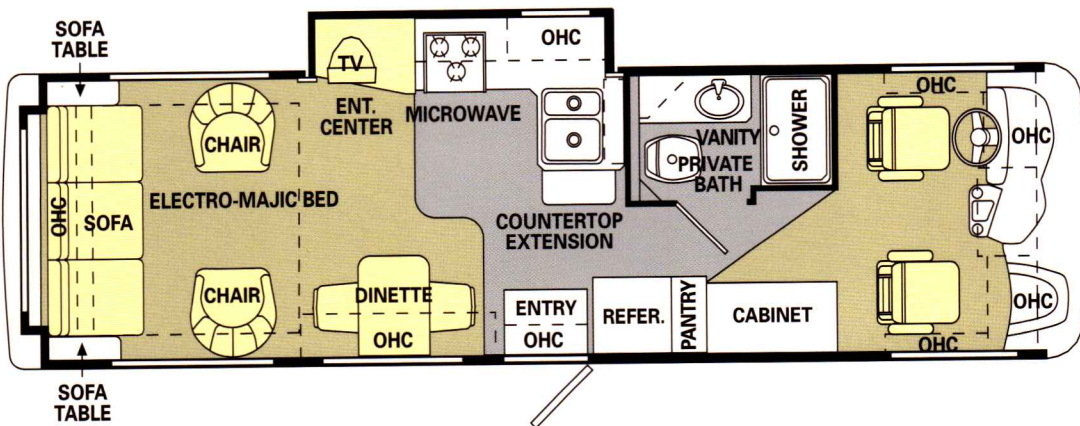

## 30 PBS

Options Include:  
 Soft Touch Vinyl Euro  
 Recliner with Ottoman  
 Two Folding Dinette Chairs  
 Fabric Electric Sofa  
 Fabric L-Sofa with Drawer  
 and One Barrel Chair

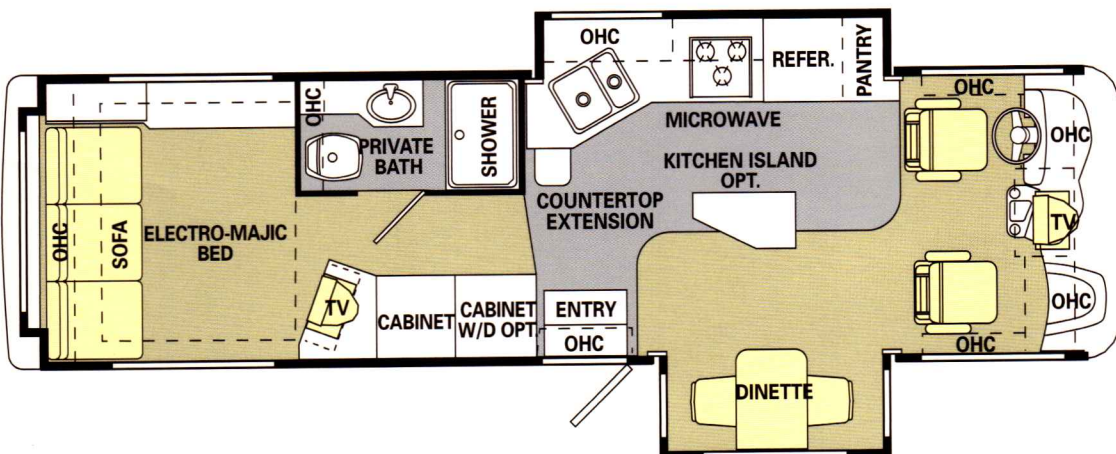

## 31 SBD

Options Include:  
 Fabric Electric Sofa  
 Fabric L-Sofa with Drawer  
 Island Kitchen  
 Two Folding Dinette Chairs



# HOLIDAY RAMBLER 2004 TRAVELER

## NOW YOU'RE ON YOUR WAY.

THE MOMENT YOU TAKE TO THE ROAD IN A NEW HOLIDAY RAMBLER, YOU'LL KNOW WHAT IT MEANS TO BECOME PART OF A RICH, COLORFUL HERITAGE. BECAUSE FROM THAT MOMENT, YOU'RE INVITED TO JOIN US WHEREVER WE GATHER — AT



RALLIES AND EVENTS ACROSS THE COUNTRY. WHEN YOU PURCHASE A NEW HOLIDAY RAMBLER, YOU ARE ELIGIBLE TO RECEIVE A FREE ONE-YEAR MEMBERSHIP IN THE HOLIDAY RAMBLER CLUB. AND

TO KEEP YOU INFORMED OF ALL THE LATEST NEWS AND EVENTS, YOU'LL ALSO RECEIVE A SUBSCRIPTION TO OUR HOLIDAYS MAGAZINE. OUR WEBSITE ALSO PROVIDES VALUABLE INFORMATION AND IS A CONVENIENT WAY TO CONTACT US

ANYTIME. IN ADDITION, YOU ARE AUTOMATICALLY ENROLLED FOR ONE YEAR IN OUR OWNER ADVANTAGE PROGRAM. WITH THIS IMPRESSIVE ROADSIDE ASSISTANCE PACKAGE, MASTER CERTIFIED RVDA TECHNICIANS AND ASE CERTIFIED TECHNICIANS ARE ON CALL 24 HOURS A DAY TO HANDLE ANY PROBLEMS YOU MAY EXPERIENCE WITH YOUR COACH. THE OWNER ADVANTAGE PROGRAM ALSO INCLUDES THE FOLLOWING BENEFITS: 24-HOUR ROADSIDE ASSISTANCE, FUEL DELIVERY, TIRE CHANGE, BATTERY JUMP START, LOCKOUT SERVICE, TRIP ROUTING AND MAPS, AND MUCH MORE.

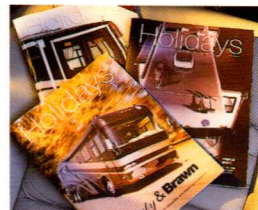

[www.holidayrambler.com](http://www.holidayrambler.com)

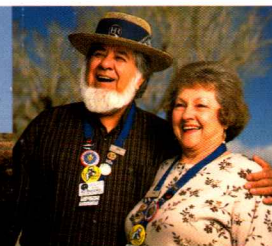

**HOLIDAY RAMBLER**  
*This is Living®*

  
MONACO COACH CORPORATION

**(800) 245-4778**

Monaco is traded on the New York Stock Exchange under the listing MNC © 2003, Monaco Coach Corporation 0903 NPN:BROHTRA Litho in USA.

**MOTOR HOME & RV  
SUPER CENTER**  
220 Station Rd, Auburn, Maine 04210  
(207) 783-1169 or 1-800-244-6686  
[www.motorhomecenter.com](http://www.motorhomecenter.com)

